

ORDINANCE NO. 6 4 6 4

AN ORDINANCE OF THE CITY COUNCIL OF THE CITY OF AUBURN, WASHINGTON, REVISING THE CORPORATE BOUNDARY OF THE CITY TO REMOVE KING COUNTY'S JURISDICTION OVER SOUTH 277<sup>TH</sup> STREET, PURSUANT TO RCW 35A.21.210

WHEREAS, The City Council annexed property on its northern boundary under Ordinance 2499 in November, 1970, which boundary was corrected in December 1970 under Ordinance 2511; and,

WHEREAS, the annexation left portions of S. 277<sup>th</sup> Street within the jurisdiction of King County; and,

WHEREAS, RCW 35A.21.210 provides a method for the City of Auburn and King County to modify the City's boundary to remove King County's jurisdiction of this portion of S. 277<sup>th</sup> Street and to convey that jurisdiction to the City of Auburn.

NOW, THEREFORE, THE CITY COUNCIL OF THE CITY OF AUBURN, WASHINGTON, DO ORDAIN as follows:

Section 1. The City of Auburn expresses its intent to include the full width of S. 277<sup>th</sup> Street, plus any associated rights-of-way, within the boundaries of the City of Auburn. A description of that portion of S. 277<sup>th</sup> Street that still remains within the boundaries and jurisdiction of King County is attached and incorporated as Exhibits A and B.

Section 2. Implementation. The Mayor is hereby authorized to implement such administrative procedures as may be necessary to carry out the directions of this legislation.

Section 3. Severability. The provisions of this ordinance are declared to be separate and severable. The invalidity of any clause, sentence, paragraph, subdivision, section or portion of this ordinance, or the invalidity of the application

thereof to any person or circumstance shall not affect the validity of the remainder of this ordinance, or the validity of its application to other persons or circumstances.

Section 4. Effective date. This Ordinance shall take effect and be in force five days from and after its passage, approval and publication as provided by law.

INTRODUCED: JUN - 3 2013

PASSED: JUN - 3 2013

APPROVED: JUN - 3 2013

  
\_\_\_\_\_  
PETER B. LEWIS, MAYOR

ATTEST:

  
\_\_\_\_\_  
Danielle E. Daskam, City Clerk

APPROVED AS TO FORM:

  
\_\_\_\_\_  
Daniel B. Heid, City Attorney

Published: June 6, 2013 - Seattle Times

## EXHIBIT A

### AUBURN WAY NORTH AND S. 277<sup>TH</sup> STREET DESCRIPTION (KING COUNTY JURISDICTIONAL AREA BEING ANNEXED TO THE CITY OF AUBURN)

THOSE PORTIONS OF THE R. H. BEATTY DONATION LAND CLAIMS, NUMBERS 37 AND 44, AND OF THE JOHN THOMAS DONATION LAND CLAIM NUMBER 42, ALL IN SECTION 36, TOWNSHIP 22 NORTH, RANGE 4 EAST, W.M. AND SECTION 31, TOWNSHIP 22 NORTH, RANGE 5 EAST, W.M. IN KING COUNTY, WASHINGTON DESCRIBED AS FOLLOWS:

BEGINNING AT THE SOUTHEAST CORNER OF THE R.H. BEATTY D.L.C. NUMBER 37, WHICH POINT IS ALSO THE NORTHEAST CORNER OF THE W. A. COX D.L.C. NUMBER 38 AND THE NORTHWEST CORNER OF THE G.E. KING D.L.C. NUMBER 40;

THENCE NORTH 88°59'57" WEST ALONG THE SOUTH LINE OF SAID BEATTY DONATION LAND CLAIMS NUMBERS 37 AND 44, THE NORTH LINE OF W. A. COX D.L.C. NUMBERS 38 AND 43, AND ALONG THE NORTH LINE OF THE LANDS ANNEXED TO THE CITY OF AUBURN BY CITY OF AUBURN ORDINANCE 2511 A DISTANCE OF 2738.77 FEET TO A POINT SOUTHERLY OF HIGHWAY ENGINEER'S STATION "276<sup>TH</sup> ST. W. 2+75", AS SHOWN ON THE MAP PREPARED BY THE STATE OF WASHINGTON DEPARTMENT OF HIGHWAYS OF SR167 (STATE ROAD NUMBER 5), KENT BRIDGE APPROACHES, SHEET 2 OF 3, CONTRACT NUMBER 1824, PRESENTLY REFERRED TO AS THE EAST VALLEY HIGHWAY, SAID POINT BEING ON THE EASTERLY LINE OF THE LANDS ANNEXED TO THE CITY OF AUBURN BY CITY OF AUBURN ORDINANCE 4770, THE DESCRIPTION OF WHICH WAS AMENDED BY CITY OF AUBURN ORDINANCE 4789;

THENCE NORTH 01°00'03" EAST ALONG SAID EASTERLY LINE A DISTANCE OF 55.59 FEET, MORE OR LESS, TO A POINT 30 FEET NORTH OF SAID HIGHWAY ENGINEER'S STATION "276<sup>TH</sup> ST. W. 2+75, SAID POINT BEING THE NORTHEAST CORNER OF SAID LANDS ANNEXED TO THE CITY OF AUBURN BY CITY OF AUBURN ORDINANCE 4770, THE DESCRIPTION OF WHICH WAS AMENDED BY CITY OF AUBURN ORDINANCE 4789;

THENCE LEAVING SAID LANDS ANNEXED TO THE CITY OF AUBURN, NORTH 86°06'06" EAST A DISTANCE OF 175.64 FEET TO A POINT 45 FEET NORTH OF HIGHWAY ENGINEER'S STATION "276<sup>TH</sup> ST. W. 1+00";

THENCE NORTH 84°48'19" EAST A DISTANCE OF 138.50 FEET, MORE OR LESS, TO THE EASTERLY LINE OF THE EAST VALLEY HIGHWAY (AKA CENTRAL AVENUE SOUTH), SAID POINT BEING AN ANGLE POINT IN THE SOUTHERLY LINE OF THE LANDS DESCRIBED IN CORRECTION QUIT CLAIM DEED RECORDED UNDER RECORDING NUMBER 20121231000964, RECORDS OF KING COUNTY, WASHINGTON;

THENCE SOUTH 79°59'33" EAST ALONG SAID SOUTHERLY LINE A DISTANCE OF 186.21 FEET TO AN ANGLE POINT IN SAID LINE;

THENCE SOUTH 1°00'03" WEST ALONG SAID SOUTHERLY LINE A DISTANCE OF 6.89 FEET TO AN ANGLE POINT IN SAID LINE WHICH IS ON THE NORTH LINE OF THE SOUTH 49.50 FEET OF SAID BEATTY DONATION LAND CLAIM;

THENCE SOUTH 88°59'57" EAST ALONG SAID NORTH LINE OF THE SOUTH 49.50 FEET OF SAID BEATTY DONATION LAND CLAIM, AND ALONG SAID SOUTHERLY LINE OF SAID LANDS DESCRIBED IN CORRECTION QUIT CLAIM DEED A DISTANCE OF 2241.80 FEET TO THE EAST LINE OF SAID BEATTY DONATION LAND CLAIM;

THENCE SOUTH 00°34'56" WEST ALONG SAID EAST LINE A DISTANCE OF 49.50 FEET TO THE POINT OF BEGINNING.

TOGETHER WITH THAT PORTION OF 86<sup>TH</sup> AVENUE SOUTH LOCATED IN THE R. H. BEATTY DONATION LAND CLAIM NUMBER 37 WITHIN SECTION 31, TOWNSHIP 22 NORTH, RANGE 5 EAST, W.M., IN KING COUNTY, WASHINGTON DESCRIBED AS FOLLOWS:

COMMENCING AT THE SOUTHEAST CORNER OF THE R.H. BEATTY D.L.C. NUMBER 37, WHICH POINT IS ALSO THE NORTHEAST CORNER OF THE W. A. COX D.L.C. NUMBER 38 AND THE NORTHWEST CORNER OF THE G.E. KING D.L.C. NUMBER 40; THENCE NORTH 00°34'56" EAST ALONG THE EAST LINE OF SAID BEATTY DONATION LAND CLAIM A DISTANCE OF 49.50 FEET TO THE NORTH LINE OF THE SOUTH 49.50 FEET OF SAID BEATTY DONATION LAND CLAIM;

THENCE NORTH 88°59'57" WEST ALONG SAID NORTH LINE A DISTANCE OF 1430.33 FEET, MORE OR LESS, TO THE EAST RIGHT OF WAY LINE OF 86<sup>TH</sup> AVENUE SOUTH AND THE POINT OF BEGINNING;

THENCE NORTH 13°31'01" WEST ALONG SAID EAST RIGHT OF WAY LINE A DISTANCE OF 69.45 FEET;

THENCE NORTH 78°07'18" WEST A DISTANCE OF 66.42 FEET, MORE OR LESS, TO THE WEST RIGHT OF WAY LINE OF 86<sup>TH</sup> AVENUE SOUTH;

THENCE SOUTH 13°31'01" EAST ALONG SAID WEST RIGHT OF WAY LINE A DISTANCE OF 82.40 FEET TO THE NORTH LINE OF THE SOUTH 49.50 FEET OF SAID BEATTY DONATION LAND CLAIM;

THENCE SOUTH 88°59'57" EAST ALONG LAST SAID NORTH LINE A DISTANCE OF 61.98 FEET TO THE POINT OF BEGINNING.

THE BASIS OF BEARINGS FOR THIS DESCRIPTION IS IDENTICAL WITH THE RIGHT OF WAY "EXHIBIT A" FOR SOUTH 272<sup>ND</sup>/277<sup>TH</sup> STREET CORRIDOR, SOUTH CENTRAL AVENUE TO KENT-KANGLEY ROAD (SR-516), SHEET 1 OF 2, PREPARED BY THE CITY OF KENT DATED 11-22-99, AND CORRECTION QUIT CLAIM DEED RECORDED UNDER RECORDING NUMBER 20121231000964, RECORDS OF KING COUNTY, WASHINGTON, BOTH OF WHICH IDENTIFY THE BEARING FOR THE SOUTH LINE OF THE R. H. BEATTY DONATION LAND CLAIM AS SOUTH 88°59'57" EAST.

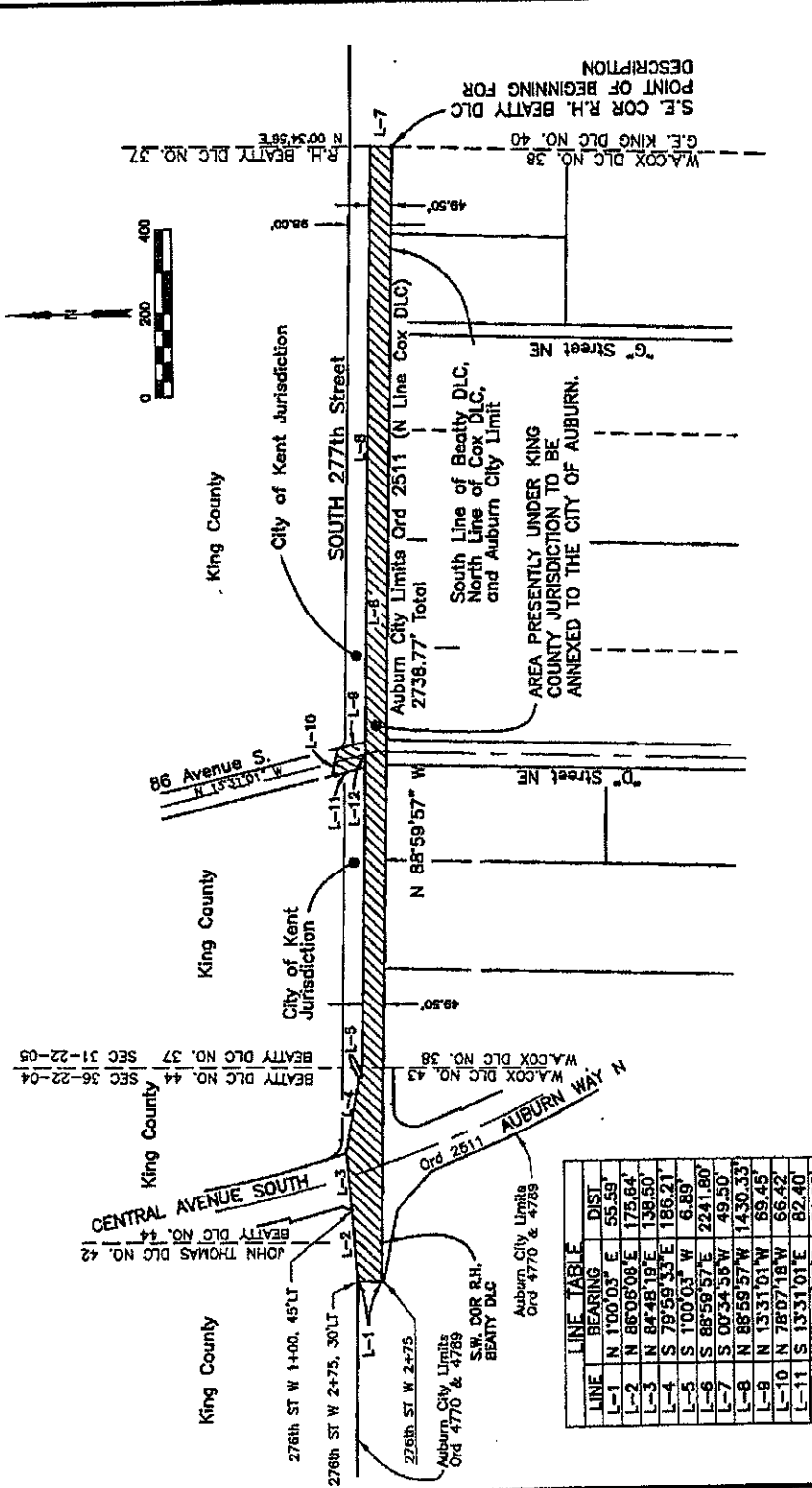

LINE	BEARING	DIST
L-1	N 1°00'03" E	55.59'
L-2	N 86°08'08" E	175.64'
L-3	N 84°48'19" E	138.50'
L-4	S 79°59'33" E	186.21'
L-5	S 1°00'03" W	6.89'
L-6	S 88°59'57" E	2241.80'
L-7	S 0°34'56" W	49.50'
L-8	N 88°59'57" W	1430.33'
L-9	N 13°31'01" W	69.45'
L-10	N 78°07'18" W	66.42'
L-11	S 13°31'01" E	82.40'
L-12	S 88°59'57" E	61.98'

THE BASIS OF BEARINGS FOR LINES SHOWN HEREON IS IDENTICAL WITH THE RIGHT OF WAY "EXHIBIT A" FOR SOUTH 272nd/277th STREET CORRIDOR, SOUTH CENTRAL AVENUE TO KENT-KANGLEY ROAD (SR-516), SHEET 1 OF 2, PREPARED BY THE CITY OF KENT DATED 11-22-99, QUIT CLAIM DEED RECORDED UNDER KING COUNTY RECORDING NUMBER 9706090895, AND CORRECTION DEED RECORDED UNDER RECORDING NUMBER 20121231000964, ALL OF WHICH IDENTIFY THE BEARING FOR THE SOUTH LINE OF THE R.H. BEATY DONATION LAND CLAIM AS SOUTH 88°59'57" EAST.

Prepared by  
**CITY OF AUBURN**  
 PUBLIC WORKS DEPARTMENT  
 ANNEXATION OF KING COUNTY JURISDICTION

**EXHIBIT "B"**  
 C222A0 SOUTH 277th STREET  
 ANNEXATION OF KING COUNTY JURISDICTION

C222A0  
 04/10/2013  
 DRAWN BY: RRB

