



# 2024 SUPPLEMENTAL CAPITAL BUDGET REQUEST

SEPTEMBER 8, 2023

## Investing in College Campuses and Climate Recovery

Our community and technical college system's \$103 million supplemental request targets reducing greenhouse gas emissions and funding two priority capital projects.

### Energy-performance standards

According to the Washington State Department of Commerce, buildings are the most rapidly growing source of greenhouse gas emissions in Washington state. The building sector is the state's second largest carbon polluter behind transportation, and accounts for 27% of statewide emissions. Investing in building energy efficiency is the most cost-effective way to significantly reduce building sector emissions.<sup>1</sup>

With full funding of this request, our colleges would:

- Install energy submeters in individual buildings to ensure compliance with energy performance standards established under the 2019 Clean Buildings Act (HB 1257) and then expanded in 2022 (SB 5722). Fast action is required to meet the first mandatory compliance date of June 1, 2026.
- Develop decarbonization plans for campuses with centralized heating and cooling plants. Decarbonization plans for campuses with centralized energy systems serving at least five buildings and more than 100,000 square feet of building space

are required under HB 1390, which sets a due date of June 30, 2024 for planning to begin, and June 30, 2025 for them to be submitted to the Department of Commerce for review and approval.

- Tune up and optimize inefficient building systems through a "retro-commissioning" grant program. The grant program would be created through this request and administered by the State Board for Community and Technical Colleges.

These investments would equip colleges to meet state energy performance standards for buildings, reduce greenhouse gas emissions, improve operational efficiencies, and avoid significant penalties, thereby preserving funding for instruction and student services.

### Priority design and construction projects

Our college system's 2024 budget request also seeks funding for two major capital projects not funded in the biennial budget: the Center for Vocational and Transitional Studies at Lower Columbia College in Longview, and the Performing Arts Building replacement at Columbia Basin College in Pasco. Funding these two requests would serve students at the two colleges while reducing a backlog of capital projects needed across Washington's 34 community and technical colleges.

Source: 1. Department of Commerce website Sept. 2, 2023: <https://www.commerce.wa.gov/growing-the-economy/energy/buildings/clean-buildings-standards/>

### 2024 SBCTC Supplemental Capital Budget Request for New Appropriations and Financing Authorities

Priority	College	Number	Project	Phase	Request	Cumulative
1	Statewide	40000878	CBPS SBCTC Statewide Utility Submeters for Clean Buildings Act	Design & Construct	\$8,544,000	\$8,544,000
2	Statewide	40000914	HB 1390 - Decarbonization Planning	Planning	\$724,000	\$9,268,000
3	Statewide	40000880	CTC Energy Efficiency Program	Grant program	\$2,000,000	\$11,268,000
4	Lower Columbia	40000106	Center for Vocational and Transitional Studies	Construction	\$43,704,000	\$54,972,000
5	Columbia Basin	40000108	Performing Arts Building Replacement	Design & Construct	\$47,876,000	\$102,848,000

### 2024 SBCTC Supplemental Capital Budget Request for Alternative Financing Authority

College	Number	Project	Authority
Renton	40000881	Building J Renovation	\$2,000,000



### CONTACT INFORMATION

**Darrell Jennings**  
Capital Budget Director  
360-704-4382  
djennings@sbctc.edu

# SBCTC 2024 Supplemental Capital Budget Request

	Page	Budget Submittal Component
	001	2024 supplemental capital request one-pager
	002	Table of contents
Tab A	003	
	004	Ten-Year Plan CBS 001
	007	FTE Summary CBS 004
	009	40000106 Lower Columbia - CVTS DAHP consultation 3Mar2022
	018	40000108 Columbia Basin - Performing Arts building DAHP consultation 10Oct2017
Tab B	019	Preservation
	020	1.1 40000878 CBPS SBCTC Statewide Utility Submeters for Clean Buildings Act CBS002
	049	1.2 40000878 Summary CTC Qualifying Buildings - Meters Needed
	053	2.0 40000914 HB 1390 Decarbonization Planning CBS002
	056	4.1 40000106 Lower Columbia - CVTS CBS002
	062	4.2 40000106 Lower Columbia - CVTS C100 17Aug2023
	076	4.3 40000106 Lower Columbia - CVTS program update 21Jul2023
	077	5.1 40000108 Columbia Basin - Performing Arts building CBS002
	083	5.2 40000108 Columbia Basin - Performing Arts building C100 15Aug2023
	097	5.3 40000108 Columbia Basin - Performing Arts building program update 15Aug2023
Tab D	098	Grants
	099	40000880 CTC Energy Efficiency Program CBS002
Tab E	103	COP
	104	40000881 Renton Technical College COP Building J Renovation request form

# TAB A

1. 10-year capital plan
2. Capital FTE Summary
3. DAHP Reviews



**699 - Community and Technical College System  
Ten Year Capital Plan by Project Class**

2023-25 Biennium

\*

Version: U1 SBCTC 2024 Supplemental Cap. Budget

Report Number: CBS001

Date Run: 9/8/2023 8:56AM

**Project Class: Preservation**

Agency Priority	Project by Account-EA Type	Estimated Total	Prior Expenditures	Current Expenditures	Reapprop 2023-25	New Approp 2023-25	Estimated 2025-27	Estimated 2027-29	Estimated 2029-31	Estimated 2031-33
<b>1</b>	<b>40000878 CBPS SBCTC Statewide: Utility Submeters for Clean Buildings Act</b>									
	060-1 Comm/Tech	170,000				170,000				
	Cap Proj A-State									
	26C-1 Climate Commit	8,374,000				8,374,000				
	Accou-State									
	<b>Project Total:</b>	<b>8,544,000</b>				<b>8,544,000</b>				
<b>2</b>	<b>40000914 HB 1390 Decarbonization Planning</b>									
	26C-1 Climate Commit	724,000				724,000				
	Accou-State									
<b>4</b>	<b>40000106 Lower Columbia: Center for Vocational and Transitional Studies</b>									
	057-1 State Bldg	43,260,251		(443,749)		43,704,000				
	Constr-State									
<b>5</b>	<b>40000108 Columbia Basin: Performing Arts Building Replacement</b>									
	057-1 State Bldg	47,876,000				47,876,000				
	Constr-State									
<b>Total: Preservation</b>		<b>100,404,251</b>		<b>(443,749)</b>		<b>100,848,000</b>				

**Project Class: Program**

Agency Priority	Project by Account-EA Type	Estimated Total	Prior Expenditures	Current Expenditures	Reapprop 2023-25	New Approp 2023-25	Estimated 2025-27	Estimated 2027-29	Estimated 2029-31	Estimated 2031-33
<b>0</b>	<b>40000881 COP for Renton Technical College Building J Renovations</b>									
	COP-6 Certificate of	2,000,000				2,000,000				
	Part-Non-Appropriated									

**Project Class: Grant**

**699 - Community and Technical College System  
Ten Year Capital Plan by Project Class**

2023-25 Biennium

\*

Version: U1 SBCTC 2024 Supplemental Cap. Budget

Report Number: CBS001

Date Run: 9/8/2023 8:56AM

**Project Class: Grant**

Agency Priority	Project by Account-EA Type	Estimated Total	Prior Expenditures	Current Expenditures	Reapprop 2023-25	New Approp 2023-25	Estimated 2025-27	Estimated 2027-29	Estimated 2029-31	Estimated 2031-33
3	40000880 CTC Energy Efficiency Program									
	26C-1 Climate Commit	2,000,000				2,000,000				
	Accou-State									

**Total Account Summary**

Account-Expenditure Authority Type	Estimated Total	Prior Expenditures	Current Expenditures	Reapprop 2023-25	New Approp 2023-25	Estimated 2025-27	Estimated 2027-29	Estimated 2029-31	Estimated 2031-33
057-1 State Bldg Constr-State	91,136,251		(443,749)		91,580,000				
060-1 Comm/Tech Cap Proj A-State	170,000				170,000				
26C-1 Climate Commit Accou-State	11,098,000				11,098,000				
COP-6 Certificate of Part-Non-Appropriated	2,000,000				2,000,000				
<b>Total</b>	<b>104,404,251</b>		<b>(443,749)</b>		<b>104,848,000</b>				

### Ten Year Capital Plan by Project Class

\*

**Report Number:** CBS001  
**Date Run:** 9/8/2023 8:56AM

<u>Parameter</u>	<u>Entered As</u>	<u>Interpreted As</u>
Biennium	2023-25	2023-25
Functional Area	*	All Functional Areas
Agency	699	699
Version	U1-A	U1-A
Project Classification	*	All Project Classifications
Include Enacted	No	No
Sort Order	Project Class	Project Class
Include Page Numbers	Y	Yes
For Word or Excel	N	N
User Group	Agency Budget	Agency Budget
User Id	*	All User Ids

Capital FTE Summary

2023-25 Biennium

\*

Version: U1 SBCTC 2024 Supplemental Cap. Budget

Report Number: CBS004

Date Run: 9/8/2023 9:00AM

**FTEs by Job Classification**

<u>Job Class</u>	Authorized Budget		2023-25 Biennium	
	2021-23 Biennium		2023-25 Biennium	
	<u>FY 2022</u>	<u>FY 2023</u>	<u>FY 2024</u>	<u>FY 2025</u>
Staff for Clean Buildings utility submeter project			0.0	1.0

**Account**

<u>Account - Expenditure Authority Type</u>	Authorized Budget		2023-25 Biennium	
	2021-23 Biennium		2023-25 Biennium	
	<u>FY 2022</u>	<u>FY 2023</u>	<u>FY 2024</u>	<u>FY 2025</u>
060-1 Comm/Tech Cap Proj A-State			0	170,000

**Narrative**

- SBCTC staff to support SBCTC and system colleges in complying with the Clean Buildings Law.
- SBCTC staff to support SBCTC and system colleges in complying with the Clean Buildings Law.
- SBCTC staff to support SBCTC and system colleges in complying with the Clean Buildings Law.
- SBCTC staff to support SBCTC and system colleges in complying with the Clean Buildings Law.
- SBCTC staff to support SBCTC and system colleges in complying with the Clean Buildings Law.
- SBCTC staff to support SBCTC and system colleges in complying with the Clean Buildings Law.
- SBCTC staff to support SBCTC and system colleges in complying with the Clean Buildings Law.
- SBCTC staff to support SBCTC and system colleges in complying with the Clean Buildings Law.
- SBCTC staff to support SBCTC and system colleges in complying with the Clean Buildings Law.

**Capital FTE Summary**  
2023-25 Biennium  
\*

**Report Number:** CBS004  
**Date Run:** 9/8/2023 9:00AM

<u>Parameter</u>	<u>Entered As</u>	<u>Interpreted As</u>
Biennium	2023-25	2023-25
Agency	699	699
Version	U1-A	U1-A
Include Page Numbers	Y	Yes
For Word or Excel	N	N
User Group	Agency Budget	Agency Budget



<b>DAHP USE ONLY</b>
Date Received: 2/17/2022
DAHP Log #: 2022-03-01300
Reviewer(s): RW & HB
<input checked="" type="checkbox"/> ARCHY <input checked="" type="checkbox"/> BEU



**EZ-1 FORM**

Request to initiate consultation for Governor's Executive Order 21-02 (GEO 21-02) projects

**GEO 21-02**

New Consultation?  YES  NO  ADDITIONAL INFORMATION PROVIDED PER REQUEST

Questions? Contact DAHP at 2102@dahp.wa.gov or (360) 586-3065. You may also find answers to your questions online at www.dahp.wa.gov/2102.

**SECTION 1: PROJECT INFORMATION**

Project Title: <b>Center for Vocational &amp; Transitional Studies</b>	Provide 1-2 sentence summary of the project. Demolition of 4 aging existing buildings at Lower Columbia College, to be replaced with 1 new building. New building will be 3 stories high, and 46,267 sf.
Property Name: <b>Lower Columbia College</b> <small>if applicable</small>	
Project Address: <b>1600 Maple Street</b>	
City / State / Zip: <b>Longview, WA 98632</b>	County: <b>Cowlitz</b> Township / Range / Section: <b>T8-0N R2-0W S2E</b> <small>leave blank if unsure</small>

**SECTION 2: PROJECT DESCRIPTION**

Project includes (check all that apply):  NEW CONSTRUCTION  DEMOLITION  GROUND DISTURBANCE  REHABILITATION / RENOVATION  ACQUISITION

Does the project involve any buildings, objects, sites, structures or districts that are over 45 years old?  YES  NO  NOT SURE \*Contact DAHP  Check here if the project involves multiple resources. If so, attach a table including all information in Sections 1 and 2 for each resource.

Does the project involve any properties determined eligible for or listed in the National Register of Historic Places or Washington Heritage Register? <input type="checkbox"/> YES <input type="checkbox"/> NO <input checked="" type="checkbox"/> NOT SURE	Is the building, structure or site already recorded in WISAARD? <input type="checkbox"/> YES <input checked="" type="checkbox"/> NO <input type="checkbox"/> NOT SURE <small>[!] See Note *Contact DAHP</small>	If Yes, what is the Property ID # or Site #? _____	<b>[!] If the resource is not recorded in WISAARD, please contact DAHP Staff. Go to www.dahp.wa.gov/wisaard for more information. Check the box when complete.</b>
--	---	--	--

Are there any Federal funds, lands, permits, or licenses involved in/required by this project?  YES  NO  NOT SURE If Yes, what Federal Agency? \_\_\_\_\_

What is the nature of your request? (Check all that apply)  PREDESIGN  DESIGN  CONSTRUCTION  APPLYING FOR GRANT / LOAN  TRYING TO GET UNDER CONTRACT  NOT SURE

**SECTION 3: STATE AGENCY INFORMATION**

State Agency: **Lower Columbia College (0657)** Grant / Loan Program Name: **none**  Direct Appropriation?

Contact Person: **Nolan Wheeler** Phone: **(360) 442-2201** e-mail: **nwheeler@lcc.ctc.edu**

Funding biennium? **2023-2025** Requested grant / loan amount: **0** Total project amount: **0**

**SECTION 4: CONTACT INFORMATION**

If different from State Agency contact person.

Submitter Name: **Matt Lane** Submitter Organization: **McGranahan Architects**

Submitter Address: **2111 Pacific Ave** City / State / Zip: **Tacoma, WA 98402**

Submitter Phone: **(253) 383-3084** Submitter e-mail: **matt.lane@mcgranahan.com**

**SECTION 5: ATTACHMENTS**

Please email completed form and all attachments to: **2102@dahp.wa.gov**

<input checked="" type="checkbox"/> MAP / APE - Be sure to show the project boundary and location of property(ies). See Section 7 on Page 3 for optional template. May also submit online through WISAARD using eAPE.	<input checked="" type="checkbox"/> SITE PLAN / DRAWINGS - Indicate location and dates of resources, proposed improvements and ground disturbance, etc.
<input checked="" type="checkbox"/> DESCRIPTION / SCOPE OF WORK - Describe the project, including any ground disturbance. See Section 6 on Page 2 for optional template.	<input checked="" type="checkbox"/> PHOTOGRAPHS - Attach digital photographs showing the project site, including images of all resources. Photos submitted through WISAARD may suffice.

**DAHP DETERMINATION (DAHP USE ONLY)**

<input type="checkbox"/> EXEMPT from GEO 21-02 review.	<input type="checkbox"/> The project will have an <b>ADVERSE IMPACT</b> on historic properties.	 DAHP REVIEWER <b>3/4/2022</b> DATE
<input checked="" type="checkbox"/> There are <b>NO HISTORIC PROPERTIES IMPACTED</b> by the proposed project.	<input type="checkbox"/> DAHP requires <b>ADDITIONAL INFORMATION</b> in order to complete review (see attached).	
<input type="checkbox"/> The project will have <b>NO ADVERSE IMPACT</b> on historic properties.	<input type="checkbox"/> SURVEY REQUIRED <input type="checkbox"/> IDP REQUIRED	
	<input type="checkbox"/> MONITORING REQUIRED	

**Instructions:** Please describe the type of work to be completed. Be as detailed as possible to avoid a request for additional information. Be sure to describe all ground disturbing activities in the appropriate box below, and provide photos of areas of work.

### SECTION 6: ADD'L PROJECT INFORMATION

**NOTE:** To save this fillable form you must fill it out in Adobe Acrobat or use the PRINT to PDF function in Acrobat Reader. In Reader choose File > Print and choose Adobe PDF as the printer. The fill will save to your computer.

Please be aware that this form may only initiate consultation. For some projects, DAHP may require additional information to complete our review such as plans, specifications, and photographs. An historic property inventory form may need to be completed by a qualified cultural resource professional.

Provide a detailed description of the proposed project:

Lower Columbia College plans to construct a new 46,267 square foot Center for Vocational and Transitional Studies, which will replace the existing Vocational, Science, Physical Science, and Steam Plant buildings. The new three-story CVTS building will house LCC's welding, machining, manufacturing, information technologies, and transitional studies programs, as well as faculty offices, informal learning areas, and support spaces. The project will also include improvements to campus accessibility, infrastructure, parking, and open space.

Describe the existing project site conditions (include building age, if applicable):

The Vocational Building was built in 1960 as an auto-shop. The 32,250 sf building is wood framed, and one-story in height.

The Science Building was built in 1960. The 6,944 sf building is wood framed, and one-story in height.

The Physical Science Building was built in 1971. The 9,551 sf building is steel framed, and one-story in height.

The Steam Plant was built in 1982. The 1,723 sf building is steel framed, and one-story in height.

If there are ground disturbing activities proposed, describe them *including the approximate depth of ground disturbance*:

The new project proposes ground disturbance at the sites of demolition, as well as the site for the proposed new building. Ground disturbance at the demolition sites would be limited to building removal, and restoration of the ground plane. Ground disturbance at the site of the new building would be for foundation work, and is dependent on the recommendations of a geotechnical engineer, but we expect that disturbance for foundation would be approximately 4 feet below grade (+/-), and that piles are likely to be required up to a much greater depth (30-50 feet below grade, for example).

Instructions: Please attach a MAP of the project area. (Use WISAARD with USA Topo Basemap background. Click HERE for Snipping Tool Tutorial. Draw an outline of the Area of Potential Effect (APE) that clearly delineates the project boundary.

SECTION 7: MAP / Area of Potential Effect

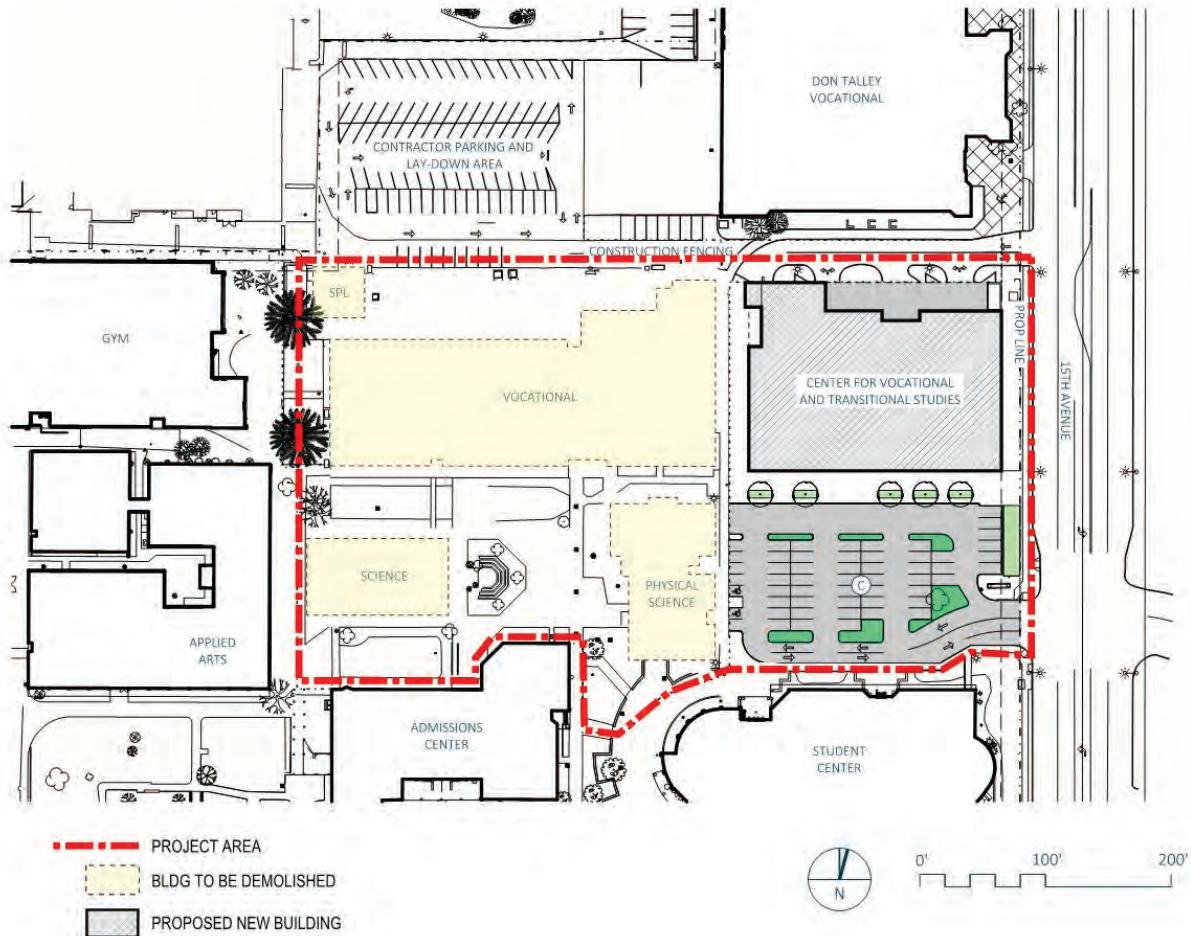



February 25, 2022

Delano Saluskin, Chairman  
Confederated Tribes and Bands of the Yakama Nation  
P.O. Box 151  
Toppenish, WA 98948

Subject: Center for Vocational and Transitional Studies  
Lower Columbia College

Dear Mr. Saluskin,

Pursuant to Governor's Executive Order 21-02, and out of respect to our local tribal communities, I am writing to inform you of Lower Columbia College's intent to construct a new instructional building located on our campus at 1600 Maple St. in Longview. The College is requesting capital funding for the project and hopes to begin construction in 2023.

We have contacted the Washington State Department of Archaeology and Historic Preservation (DAHP) and have submitted all relevant forms for consideration. We will provide any and all information to DAHP should a further review be required.

In addition, Lower Columbia College is committed to the immediate stoppage of work if any archaeological resources are discovered during construction.

If you have any comments or concerns regarding this matter, please direct them to Nolan Wheeler, VP of Administration, by phone at (360) 442-2201 or by email at [nwheeler@lowercolumbia.edu](mailto:nwheeler@lowercolumbia.edu) by March 11, 2022.

Respectfully,

A handwritten signature in blue ink, appearing to read "C. Bailey", is written over a faint, larger signature.

Christopher C. Bailey, J.D.  
President  
Lower Columbia College

1600 Maple Street

P.O. Box 3010

Longview, WA 98632

(360) 442-2311

[lowercolumbia.edu](http://lowercolumbia.edu)





February 25, 2022

Cheryle A. Kennedy, Chairwoman  
Confederated Tribes of Grand Ronde  
9615 Grand Ronde Road  
Grand Ronde, OR 97347

Subject: Center for Vocational and Transitional Studies  
Lower Columbia College

Dear Ms. Kennedy,

Pursuant to Governor's Executive Order 21-02, and out of respect to our local tribal communities, I am writing to inform you of Lower Columbia College's intent to construct a new instructional building located on our campus at 1600 Maple St. in Longview, WA. The College is requesting capital funding for the project and hopes to begin construction in 2023.

We have contacted the Washington State Department of Archaeology and Historic Preservation (DAHP) and have submitted all relevant forms for consideration. We will provide any and all information to DAHP should a further review be required.

In addition, Lower Columbia College is committed to the immediate stoppage of work if any archaeological resources are discovered during construction.

If you have any comments or concerns regarding this matter, please direct them to Nolan Wheeler, VP of Administration, by phone at (360) 442-2201 or by email at [nwheeler@lowercolumbia.edu](mailto:nwheeler@lowercolumbia.edu) by March 11, 2022.

Respectfully,

A handwritten signature in blue ink, appearing to read "C. Bailey", with a long horizontal flourish extending to the right.

Christopher C. Bailey, J.D.  
President  
Lower Columbia College

1600 Maple Street

P.O. Box 3010

Longview, WA 98632

(360) 442-2311

[lowercolumbia.edu](http://lowercolumbia.edu)



February 25, 2022

Raymond Tsumpti, Chairman  
Confederated Tribes of Warm Springs Reservation of Oregon  
PO Box 1299  
Warm Springs, OR 97761

Subject: Center for Vocational and Transitional Studies  
Lower Columbia College

Dear Mr. Tsumpti,

Pursuant to Governor's Executive Order 21-02, and out of respect to our local tribal communities, I am writing to inform you of Lower Columbia College's intent to construct a new instructional building located on our campus at 1600 Maple St. in Longview. The College is requesting capital funding for the project and hopes to begin construction in 2023.

We have contacted the Washington State Department of Archaeology and Historic Preservation (DAHP) and have submitted all relevant forms for consideration. We will provide any and all information to DAHP should a further review be required.

In addition, Lower Columbia College is committed to the immediate stoppage of work if any archaeological resources are discovered during construction.

If you have any comments or concerns regarding this matter, please direct them to Nolan Wheeler, VP of Administration, by phone at (360) 442-2201 or by email at [nwheeler@lowercolumbia.edu](mailto:nwheeler@lowercolumbia.edu) by March 11, 2022.

Respectfully,

A handwritten signature in blue ink, appearing to read "C. Bailey", is written over a horizontal line.

Christopher C. Bailey, J.D.  
President  
Lower Columbia College

1600 Maple Street

P.O. Box 3010

Longview, WA 98632

(360) 442-2311

lowercolumbia.edu



February 25, 2022

David Barnett, Executive General Council Chair  
Cowlitz Indian Tribe  
1055 9<sup>th</sup> Avenue Suite B  
Longview, WA 98632

Subject: Center for Vocational and Transitional Studies  
Lower Columbia College

Dear Mr. Barnett,

Pursuant to Governor's Executive Order 21-02, and out of respect to our local tribal communities, I am writing to inform you of Lower Columbia College's intent to construct a new instructional building located on our campus at 1600 Maple St. in Longview. The College is requesting capital funding for the project and hopes to begin construction in 2023.

We have contacted the Washington State Department of Archaeology and Historic Preservation (DAHP) and have submitted all relevant forms for consideration. We will provide any and all information to DAHP should a further review be required.

In addition, Lower Columbia College is committed to the immediate stoppage of work if any archaeological resources are discovered during construction.

If you have any comments or concerns regarding this matter, please direct them to Nolan Wheeler, VP of Administration, by phone at (360) 442-2201 or by email at [nwheeler@lowercolumbia.edu](mailto:nwheeler@lowercolumbia.edu) by March 11, 2022.

Respectfully,

A handwritten signature in blue ink, appearing to read "C. Bailey", with a long horizontal line extending to the right.

Christopher C. Bailey, J.D.  
President  
Lower Columbia College

1600 Maple Street

P.O. Box 3010

Longview, WA 98632

(360) 442-2311

lowercolumbia.edu





February 25, 2022

Kristopher Peters, Chairman  
Squaxin Island Tribe  
10 SE Squaxin Lane  
Shelton, WA 98584

Subject: Center for Vocational and Transitional Studies  
Lower Columbia College

Dear Mr. Peters,

Pursuant to Governor's Executive Order 21-02, and out of respect to our local tribal communities, I am writing to inform you of Lower Columbia College's intent to construct a new instructional building located on our campus at 1600 Maple St. in Longview. The College is requesting capital funding for the project and hopes to begin construction in 2023.

We have contacted the Washington State Department of Archaeology and Historic Preservation (DAHP) and have submitted all relevant forms for consideration. We will provide any and all information to DAHP should a further review be required.

In addition, Lower Columbia College is committed to the immediate stoppage of work if any archaeological resources are discovered during construction.

If you have any comments or concerns regarding this matter, please direct them to Nolan Wheeler, VP of Administration, by phone at (360) 442-2201 or by email at [nwheeler@lowercolumbia.edu](mailto:nwheeler@lowercolumbia.edu) by March 11, 2022.

Respectfully,

Christopher C. Bailey, J.D.  
President  
Lower Columbia College

1600 Maple Street

P.O. Box 3010

Longview, WA 98632

(360) 442-2311

[lowercolumbia.edu](http://lowercolumbia.edu)

[Back to Table of Contents](#)



## DAHP APPLICATION MATERIAL

---



Allyson Brooks Ph.D., Director  
State Historic Preservation Officer

December 10, 2015

Mr. Richard Hamilton  
Director of Facilities  
Lower Columbia Community College  
1600 Maple Street  
Longview, WA 98632

In future correspondence please refer to:  
Log: 121015-40-WBCTC  
Property: Lower Columbia Community College  
Re: No Historic Properties Affected

Dear Mr. Hamilton:

Thank you for contacting the Washington State Department of Archaeology and Historic Preservation (DAHP). The above referenced project has been reviewed by Dr. Rob Whitlam and myself on behalf of the State Historic Preservation Officer under provisions of Governor's Executive Order 05-05. My review is based upon documentation contained in your communication.

We concur that no historic properties will be affected by the removal of the Physical Sciences, Vocational, and Science Buildings as proposed. If additional information on the project becomes available, or if any archaeological resources are uncovered during construction, please halt work in the area of discovery and contact the appropriate Native American Tribes and DAHP for further consultation.

Thank you for the opportunity to review and comment. Should you have any questions, please contact me.

Sincerely,

Russell Holter  
Project Compliance Reviewer  
(360) 586-3533  
russell.holter@dahp.wa.gov





Allyson Brooks Ph.D., Director  
State Historic Preservation Officer

October 10, 2017

Mr. Wayne Doty  
Director of Capital Budgets  
WA State Board for Community and Technical Colleges  
MS 42495  
Olympia, WA 98504-2495

In future correspondence please refer to:

Project Tracking Code: 2017-09-06972  
Property: Columbia Basin College P, C, and K Buildings  
Re: Determined Eligible

Dear Mr. Doty:

Recently, the State Historic Preservation Officer (SHPO) and the Washington State Department of Archaeology and Historic Preservation (DAHP) were contacted by RGU Architecture regarding the proposed demolition of the structures at Columbia Basin College in Pasco.

We concur with their professional opinion that Buildings C and K are not eligible to the National Register of Historic Places. However, Building P (the Performing Arts Building) is a historic property that is eligible to the National Register. Concurrence on their eligibility determination is based upon the fact that the Building P is an American Institute of Architects National Award winning project. Building P is one of only two AIA National Award winning projects in the state.

We look forward to further consultation regarding your determination of the project effect on National Register listed eligible property in the area of potential impact (API).

Please provide us any correspondence or comments from concerned tribes and other parties that you receive as you consult under the requirements of Governor's Executive Order 05-05 (GEO 05-05). These comments are based on the information available at the time of this review and on behalf of the SHPO pursuant to GEO 05-05. Should additional information become available, our assessment may be revised.

Thank you for the opportunity to review and comment. Should you have any questions, please feel free to contact me at (360) 586-3533 and [russell.holter@dahp.wa.gov](mailto:russell.holter@dahp.wa.gov)

Sincerely,

Russell Holter  
Project Compliance Reviewer  
Cc: Jeff Adams (Pasco)  
Chris Moore (WA-Trust)  
Eugenia Woo (Docomomo)



# TAB B – Preservation Projects

1. CBPS SBCTC Statewide Utility Submeters for Clean Buildings ACT
2. HB 1390 – Decarbonization Planning
3. Lower Columbia: Center for Vocational and Transitional Studies
4. Columbia Basin: Performing Arts Building Replacement



# 699 - Community and Technical College System Capital Project Request

2023-25 Biennium

\*

Version: U1 SBCTC 2024 Supplemental Cap. Budget

Report Number: CBS002

Date Run: 9/8/2023 8:52AM

Project Number: 40000878

Project Title: CBPS SBCTC Statewide: Utility Submeters for Clean Buildings Act

## Description

Starting Fiscal Year: 2024

Project Class: Preservation

Agency Priority: 1

### Project Summary

RCW 19.27A.210 establishes a state Clean Buildings Performance Standard to report energy consumption and meet energy use targets by building. Over 60% of community and technical college buildings lack utility submeters necessary to collect the required baseline energy data as required by the law. This project installs utility submeters for qualifying buildings to collect energy consumption information and establish the required energy use intensity as required by the Clean Buildings Performance Standard.

### Project Description

**What is the problem/opportunity? Identify: priority, under-served people/communities, operating budget savings, public safety improvements & clarifying details. Preservation projects: include information about the current condition of the facility/system.**

According to the Washington State Department of Commerce, buildings are the most rapidly growing source of greenhouse gas emissions in Washington state. The building sector is the state's second largest carbon polluter behind transportation, and accounts for 27% of statewide emissions. Investing in building energy efficiency is the most cost-effective way to significantly reduce emissions. Clean buildings are a key component to meeting the state's climate goals.

To advance the state's climate goals, the Legislature in 2019 passed HB 1257 (RCW 19.27A.210), which established a Clean Buildings Performance Standard for Washington state and charged the state Department of Commerce with implementing rules to achieve the standard. It requires all qualifying commercial buildings 50,000 square feet and larger (Tier 1 buildings) to meet energy performance targets based on the type and use of the building. A building's performance target is called an "Energy Use Intensity Target (EUIt)."

To comply with the Clean Buildings Performance Standard, Tier 1 building owners must:

- Benchmark and report energy use for 12 consecutive months for each building to establish an energy performance target. Energy benchmarking requires a submeter for each energy source imported and exported from a building.
- Meet the building's established energy performance target. If building owners cannot calculate an energy performance target, or are above the target, they must invest in energy efficiency measures identified through an energy audit.
- Develop and implement building-level operation and maintenance programs and energy management plans to support energy-efficient operations.

Compliance dates are staggered based on building size:

- Tier 1A: 220,001+ square feet, compliance date of June 1, 2026
- Tier 1B: 90,001 - 220,000 square feet, compliance date of June 1, 2027
- Tier 1C: 50,001 - 90,000 square feet, compliance date of June 1, 2028
- Tier 2: 20,000 - 50,000 square feet, compliance date of July 1, 2027. The Legislature created this tier in 2022. Like Tier 1 building owners, Tier 2 building owners must benchmark and report energy use for 12 consecutive months and develop and implement building-level operations and maintenance programs. However, the Department of Commerce will make decisions about energy performance targets and compliance for Tier 2 buildings in the future.

This supplemental capital budget request addresses a compliance-capability problem: 197 of the 332 Tier 1 and Tier 2 buildings across Washington's 34 community and technical colleges need at least one type of utility submeter to comply with the Clean Buildings Performance Standard. Compliance penalties are up to \$1 per square foot for Tier 1 buildings, and up to \$0.30 per square foot for Tier 2 buildings. Estimated penalties for just Tier 1A buildings during the first compliance period are \$1.7 million across the college system.

# 699 - Community and Technical College System Capital Project Request

2023-25 Biennium

\*

Version: U1 SBCTC 2024 Supplemental Cap. Budget

Report Number: CBS002

Date Run: 9/8/2023 8:52AM

Project Number: 40000878

Project Title: CBPS SBCTC Statewide: Utility Submeters for Clean Buildings Act

## Description

### What will this request produce or construct?

This request will provide funding for colleges to contract for the purchase and installation of utility submeters in qualifying Tier 1 and Tier 2 buildings. Below is a summary of the colleges and number of buildings by compliance tier that need utility meters to benchmark and report building energy consumption:

Tier 1A: Colleges with buildings 220,001+ square feet; compliance no later than June 1, 2026

- 4 colleges
- 4 buildings, 1,174,051 square feet
- 7 utility meters

Tier 1B: Colleges with buildings between 90,000 – 220,000 square feet; compliance no later than June 1, 2027

- 10 colleges
- 15 buildings, 1,746,234 square feet
- 26 utility meters

Tier 1C: Colleges with buildings between 50,000 – 90,000 square feet; compliance no later than June 1, 2028

- 25 colleges
- 60 buildings, 3,983,445 square feet
- 128 utility meters

Tier 2: Colleges with buildings between 20,000 – 50,000 square feet; mandatory reporting July 1, 2027

- 28 colleges
- 118 buildings, 3,923,714 square feet
- 254 utility meters

This request will also provide SBCTC with 1 FTE to support SBCTC and system colleges in complying with the Clean Buildings Performance Standard, implementing energy and resource conservation strategies, and developing system budget priorities.

### How would the request address the problem or opportunity identified in question 1? What would be the result of not taking action?

Installing building energy submeters will enable colleges to measure and benchmark building energy use requirements for Tier 1 buildings and meet reporting requirements for Tier 2 buildings. Colleges will be able to measure electricity consumption, natural gas consumption, and thermal energy use and distribution (including steam, hot water, and chilled water) for each qualifying building.

The State Board for Community and Technical Colleges (SBCTC) will allocate funds to colleges as soon as the budget is enacted and allow colleges to implement projects immediately. Timing is urgent because the first compliance deadline of June 2026 is quickly approaching. If the Legislature funds this request, colleges would receive funding July 1, 2024. Colleges would need to quickly purchase and install the meters, gather 12 months of data to identify their performance targets, and then bring buildings into compliance by 2026.

Taking no action will leave buildings unmetered and at risk of fines by the State Department of Commerce for non-compliance. Compliance penalties are up to \$1 per square foot for Tier 1 buildings, and up to \$0.30 per square foot for Tier 2 buildings.

# 699 - Community and Technical College System Capital Project Request

2023-25 Biennium

\*

Version: U1 SBCTC 2024 Supplemental Cap. Budget

Report Number: CBS002

Date Run: 9/8/2023 8:52AM

Project Number: 40000878

Project Title: CBPS SBCTC Statewide: Utility Submeters for Clean Buildings Act

## Description

### What alternatives were explored? Why was the recommended alternative chosen?

The alternatives are already laid out in RCW 19.27A.210 and are potentially far more expensive and time-consuming than simply submetering buildings to determine exactly which buildings need investments to lower energy consumption.

Under the Clean Buildings Performance Standards, building owners must gather 12 months of energy-use data to set energy performance targets and then meet those targets or – in the absence of the data from submeters -- implement “bundled” energy efficiency measures based on an energy audit and life-cycle cost analysis. The latter option would likely be more expensive and less effective because, without submeters at the source of each energy source of a building, it would be difficult to know whether a building was wasting energy in the first place and, if so, how to target solutions to the right problems. Additionally, without knowing each buildings measured energy use, the same buildings would require another energy audit and more efficiency measures in subsequent 5-year compliance periods.

Building owners who have Tier 1 buildings that fail to comply with RCW 19.27A by the established compliance date are assessed fines each 5-year compliance period. Compliance penalties are up to \$1 per square foot for Tier 1 buildings, and up to \$0.30 per square foot for Tier 2 buildings. Estimated penalties for just Tier 1A buildings during the first compliance period are \$1.7 million across the college system. This option would have a detrimental impact on college operating budgets and thus to students and taxpayers.

### Which clientele would be impacted by the budget request?

This project will affect the nearly 272,000 students who enroll in Washington’s 34 community and technical colleges each year. Students, staff and visitors will benefit from greater energy efficiency, reduced operating costs, and progress toward achieving the state’s climate goals.

### Does this project or program leverage non-state funding? If yes, how much by source?

No.

### Describe how this project supports the agency’s strategic master plan or would improve agency performance.

This capital project request supports Goal 4 of SBCTC’s strategic plan: “Secure resources and develop systemwide strategies to support colleges’ financial sustainability and resiliency.” This project will support colleges’ financial health by measuring building energy use, finding operating efficiencies and savings through improved efficiencies, and avoiding non-compliance penalties.

### Does this project include IT related costs, including hardware, software, cloud-based services, contracts or staff?

No.

### Is the project linked to the Puget Sound Action Agenda?

No.

### How does this project contribute to meeting the greenhouse gas emissions limits established in RCW 70A.45.050, Clean Buildings performance standards in RCW 19.27A.210, or other statewide goals to reduce carbon pollution and/or improve efficiency?

This project will enable colleges to bring their Tier 1 buildings into compliance with the Clean Buildings Performance Standard. Individually submetering buildings will also enable colleges to develop and implement energy management programs for specific building conditions based on actual energy use. Managing buildings using campus-level energy data is inefficient and not targeted. Individually submetering buildings will enable colleges to strategically guide investments in the buildings and systems that will achieve the most cost-effective and efficient results.

### How does this project impact equity in the state?

**699 - Community and Technical College System  
Capital Project Request**

2023-25 Biennium

\*

Version: U1 SBCTC 2024 Supplemental Cap. Budget

Report Number: CBS002

Date Run: 9/8/2023 8:52AM

Project Number: 40000878

Project Title: CBPS SBCTC Statewide: Utility Submeters for Clean Buildings Act

**Description**

Washington's community and technical colleges serve nearly 272,000 students each year across 34 colleges throughout the state. Our colleges are inclusive and diverse. Our students are more likely to be the first in their families to attend college, come from lower-income families, be people of color, hold down jobs, and care for parents or children. The median age is 26.

This project will also benefit students with a wide array of goals, from learning basic skills, training for careers, or transferring to another college or university.

With funding from the Legislature, colleges will be able to avoid fines and safeguard themselves from having to take unnecessary, costly, and overly broad measures because they couldn't measure energy use. Savings will be put to good use instructing and serving students instead.

**Location**

City: Statewide

County: Statewide

Legislative District: 098

**Project Type**

Health, Safety and Code Requirements (Minor Works)

**Growth Management impacts**

N/A

**Funding**

Acct Code	Account Title	Estimated Total	Expenditures		2023-25 Fiscal Period	
			Prior Biennium	Current Biennium	Reappropriations	New Appropriations
060-1	Comm/Tech Cap Proj A-State	170,000				170,000
26C-1	Climate Commit Accou-State	8,374,000				8,374,000
	<b>Total</b>	<b>8,544,000</b>	<b>0</b>	<b>0</b>	<b>0</b>	<b>8,544,000</b>
			<b>Future Fiscal Periods</b>			
			<u>2025-27</u>	<u>2027-29</u>	<u>2029-31</u>	<u>2031-33</u>
060-1	Comm/Tech Cap Proj A-State					
26C-1	Climate Commit Accou-State					
	<b>Total</b>		<b>0</b>	<b>0</b>	<b>0</b>	<b>0</b>

**Operating Impacts**

No Operating Impact

**SubProjects**

SubProject Number: 40000908

SubProject Title: Spokane Falls Community College: CBPS Utility Meters

699 - Community and Technical College System  
Capital Project Request

2023-25 Biennium

\*

Version: U1 SBCTC 2024 Supplemental Cap. Budget

Report Number: CBS002

Date Run: 9/8/2023 8:52AM

Project Number: 40000878

Project Title: CBPS SBCTC Statewide: Utility Submeters for Clean Buildings Act

**SubProjects**

SubProject Number: 40000908

SubProject Title: Spokane Falls Community College: CBPS Utility Meters

Starting Fiscal Year: 2024

Project Class: Preservation

Agency Priority: 1

**Project Summary**

Installation of Tier 2 building utility submeters

**Project Description**

Install utility grade submeters for the following buildings to measure and record building energy usage to calculate energy use target in compliance with the Clean Buildings Act:

Tier 2 buildings:

- Classroom/Admin building 19, (A03711), 1 electric, 1 gas meters
- Classroom/Admin building 5, (A06764), 1 electric, 1 gas meters
- Classroom/Admin building 30, (A12985), 1 electric, 1 gas meters
- Human Services building, (A08600), 1 electric, 1 gas meters
- Science and Math building, (A01955), 1 electric, 1 gas meters

Starting Fiscal Year: 2024

Project Class: Preservation

Agency Priority: 1

**Project Summary**

Installation of Tier 1 building utility submeter

**Project Description**

Install utility grade submeters for the following building to measure and record building energy usage to calculate energy use target in compliance with the Clean Buildings Act:

Tier 1C building:

- H.C. Joe Harned Center for Health Careers, (A21056), 1 electric meter

Starting Fiscal Year: 2024

Project Class: Preservation

Agency Priority: 1

**Project Summary**

Installation of Tier 1 and Tier 2 building utility submeters

**Project Description**

Install utility grade submeters for the following buildings to measure and record building energy usage to calculate energy use target in compliance with the Clean Buildings Act:

Tier 1A building:



699 - Community and Technical College System  
Capital Project Request

2023-25 Biennium

\*

Version: U1 SBCTC 2024 Supplemental Cap. Budget

Report Number: CBS002

Date Run: 9/8/2023 8:52AM

Project Number: 40000878

Project Title: CBPS SBCTC Statewide: Utility Submeters for Clean Buildings Act

**SubProjects**

SubProject Number: 40000910

SubProject Title: Walla Walla Community College: CBPS Utility Meters

- Main building, (A02150), 5 electric, 2 BTU meters

Tier 1C building:

- Vocational Technical, (A05479), 4 electric, 2 BTU meters

Tier 2 buildings:

- Clarkston Main Building, (A06271), 1 gas, 2 BTU meters
- Dietrich Activity Center, (A00144), 1 electric, 1 BTU meters
- Health Science / Performing Arts, (A09551), 2 BTU meters
- Technology Center, (A07510), 1 electric, 1 BTU meters
- Water Environmental Science, (A02875), 2 BTU meters

Starting Fiscal Year: 2024

Project Class: Preservation

Agency Priority: 1

**Project Summary**

Installation of Tier 1 and Tier 2 building utility submeters

**Project Description**

Install utility grade submeters for the following buildings to measure and record building energy usage to calculate energy use target in compliance with the Clean Buildings Act:

Tier 1C building:

- Wenatchi Hall, (A06617), 1 BTU meter

Tier 2 buildings:

- Batjer, (A04052), 1 BTU meter
- Brown Library, (A02712), 2 BTU meters
- Mistic and Art Center, (A11095), 1 BTU meter

Starting Fiscal Year: 2024

Project Class: Preservation

Agency Priority: 1

**Project Summary**

Installation of Tier 1 and Tier 2 building utility submeters

**Project Description**

Install utility grade submeters for the following buildings to measure and record building energy usage to calculate energy use target in compliance with the Clean Buildings Act:

Tier 1C building:

- Deccio building, (A09012), 1 electric meter

Tier 2 buildings:

- Hopf Union building, (A03561), 1 electric meter
- Prior building, (A03366), 1 electric meter
- Raymond Hall, (A03586), 1 electric meter

699 - Community and Technical College System  
Capital Project Request

2023-25 Biennium

\*

Version: U1 SBCTC 2024 Supplemental Cap. Budget

Report Number: CBS002

Date Run: 9/8/2023 8:52AM

Project Number: 40000878

Project Title: CBPS SBCTC Statewide: Utility Submeters for Clean Buildings Act

**SubProjects**

SubProject Number: 40000913

SubProject Title: Yakima Valley College: CBPS Utility Meters

- Sherar Gym, (A01980), 1 electric meter

Starting Fiscal Year: 2024

Project Class: Preservation

Agency Priority: 1

**Project Summary**

SBCTC capital budget program and energy conservation support.

**Project Description**

SBCTC capital budget staffing to support the community and technical college system for CBPS facility management and energy conservation work. Includes salary, benefits, travel and equipment for thirteen months.

Starting Fiscal Year: 2024

Project Class: Preservation

Agency Priority: 1

**Project Summary**

Installation of Tier 1 and Tier 2 building utility submeters.

**Project Description**

Install utility grade submeters for the following buildings to measure and record building energy usage to calculate energy use target in compliance with the Clean Buildings Act:

Tier 1B buildings:

- East Annex - Bldg C, (A04062), 2 BTU meters

- Main Bldg A, (A03217), 2 BTU meters

Tier 1C buildings:

- Advanced Technology Building, (A21454), 2 BTU meters

- Building B, (A00368), 1 gas meter

Tier 2 buildings:

- Bldg A, (A01591), 1 gas meter

- Bldg C, (A00042), 1 gas meter

- Bldg D, (A05138), 1 gas meter

- Bldg E, (A06330), 2 BTU meters

Starting Fiscal Year: 2024

Project Class: Preservation

Agency Priority: 1

**Project Summary**

Installation of Tier1 and Tier 2 building utility submeters

**Project Description**

Install utility grade submeters for the following buildings to measure and record building energy usage to calculate energy use target in compliance with the Clean Buildings Act:

699 - Community and Technical College System  
Capital Project Request

2023-25 Biennium

\*

Version: U1 SBCTC 2024 Supplemental Cap. Budget

Report Number: CBS002

Date Run: 9/8/2023 8:52AM

Project Number: 40000878

Project Title: CBPS SBCTC Statewide: Utility Submeters for Clean Buildings Act

**SubProjects**

SubProject Number: 40000882

SubProject Title: Bellevue College: CBPS Utility Meters

Tier 1B building:

- Housing, (A25564), 1 gas meter

Tier 1C building:

- Student Success Center, (A27014), 1 gas meter

Tier 2 building:

- V building, (A10483), 1 gas meter

Starting Fiscal Year: 2024

Project Class: Preservation

Agency Priority: 1

**Project Summary**

Installation of Tier 1 and Tier 2 building utility submeters

**Project Description**

Install utility grade submeters for the following buildings to measure and record building energy usage to calculate energy use target in compliance with the Clean Buildings Act:

Tier 1C buildings:

- Campus Center, (A10177), 1 electric meter
- Morse Center, (A03694), 1 electric meter

Tier 2 buildings:

- Building B, (A00826), 1 electric meter
- Desmond McCardle Center, (A04501), 1 electric meter
- Haskell Center, (A09956), 1 electric meter

Starting Fiscal Year: 2024

Project Class: Preservation

Agency Priority: 1

**Project Summary**

Installation of Tier 1 and Tier 2 building utility submeters

**Project Description**

Install utility grade submeters for the following buildings to measure and record building energy usage to calculate energy use target in compliance with the Clean Buildings Act:

Tier 1B building:

- Workforce Education Center, (A26036), 1 gas meter

Tier 1C building:

- Library / Atec, (A06637), 1 gas meter

Tier 2 buildings:

- Aircraft Hanger, (A03411), 1 gas, 1 steam meters
- Airframe & Powerplant, (A07007), 1 gas meter

699 - Community and Technical College System  
Capital Project Request

2023-25 Biennium

\*

Version: U1 SBCTC 2024 Supplemental Cap. Budget

Report Number: CBS002

Date Run: 9/8/2023 8:52AM

Project Number: 40000878

Project Title: CBPS SBCTC Statewide: Utility Submeters for Clean Buildings Act

**SubProjects**

SubProject Number: 40000884

SubProject Title: Big Bend Community College: CBPS Utility Meters

Starting Fiscal Year: 2024

Project Class: Preservation

Agency Priority: 1

**Project Summary**

Installation of Tier 1 and Tier 2 building utility submeters

**Project Description**

Install utility grade submeters for the following buildings to measure and record building energy usage to calculate energy use target in compliance with the Clean Buildings Act:

Tier 1B building:

- Cascadia I, (A03343), 1 electric, 1 gas, 1 BTU meters

Tier 1C building:

- Global Learning and the Arts, (A07969), 2 electric, 1 gas, 1 BTU meters

Starting Fiscal Year: 2024

Project Class: Preservation

Agency Priority: 1

**Project Summary**

Installation of Tier 1 and Tier 2 building utility submeters

**Project Description**

Install utility grade submeters for the following buildings to measure and record building energy usage to calculate energy use target in compliance with the Clean Buildings Act:

Tier 2 buildings:

- Kirk Library, (A07720), 1 electric meter

- Technology Center, (A06178), 1 electric meter

- Transitional Services Building, (A01114), 1 electric meter

Starting Fiscal Year: 2024

Project Class: Preservation

Agency Priority: 1

**Project Summary**

Installation of Tier 1 and Tier 2 building utility submeters

**Project Description**

Install utility grade submeters for the following buildings to measure and record building energy usage to calculate energy use target in compliance with the Clean Buildings Act:

Tier 1B building:

**699 - Community and Technical College System  
Capital Project Request**

2023-25 Biennium

\*

Version: U1 SBCTC 2024 Supplemental Cap. Budget

Report Number: CBS002

Date Run: 9/8/2023 8:52AM

Project Number: 40000878

Project Title: CBPS SBCTC Statewide: Utility Submeters for Clean Buildings Act

**SubProjects**

**SubProject Number: 40000887**

**SubProject Title: Clark College: CBPS Utility Meters**

- Gaiser Hall, (A09419), 1 electric, 1 gas, 2 BTU meters
- Tier 1C buildings:
- STEM building, (A21460), 1 electric, 1 gas, 2 BTU meters
- Clark College @ CTC, (A08429), 1 electric, 1 gas, 2 BTU meters
- Clark College @ WSUV, (A04241), 1 electric, 1 gas, 2 BTU meters
- Tier 2 buildings:
- Applied Arts II, (A01067), 1 electric, 1 gas, 2 BTU meters
- Applied Arts IV, (A00631), 1 electric, 2 BTU meters
- Applied Arts V, (A08430), 1 electric, 2 BTU meters
- Baird Administration, (A04257), 1 electric, 2 BTU meters
- Bauer Hall, (A05212), 1 electric, 2 BTU meters
- Cannell Library, (A08326), 1 electric, 2 BTU meters
- Facilities Services, (A06744), 1 electric, 1 gas meters
- Frost Arts Center, (A06742), 1 electric, 1 gas, 2 BTU meters
- O'Connell Sport Center, (A04234), 1 electric, 1 gas, 2 BTU meters
- Pechanec Hall, (A03068), 1 electric, 2 BTU meters
- Penguin Union Building, (A06964), 1 electric, 2 BTU meters
- Scarpelli Hall, (A00594), 1 electric, 2 BTU meters
- T building, (A07270), 1 electric, 1 gas, 1 BTU meters

**Starting Fiscal Year:** 2024

**Project Class:** Preservation

**Agency Priority:** 1

**Project Summary**

Installation of Tier 1 and Tier 2 building utility submeters

**Project Description**

Install utility grade submeters for the following buildings to measure and record building energy usage to calculate energy use target in compliance with the Clean Buildings Act:

Tier 1C buildings:

- Transportation Trades, (A02550), 1 gas meter
- South Hill Campus, (A09957), 1 electric, 1 gas meters

Tier 2 buildings:

- Communications, (A03622), 1 electric, 1 gas meters
- Health Occupations, (A00602), 1 gas meter

**Starting Fiscal Year:** 2024

**Project Class:** Preservation

**Agency Priority:** 1

**Project Summary**

Installation of Tier 1 and Tier 2 building utility submeters

**Project Description**

# 699 - Community and Technical College System Capital Project Request

2023-25 Biennium

\*

Version: U1 SBCTC 2024 Supplemental Cap. Budget

Report Number: CBS002

Date Run: 9/8/2023 8:52AM

Project Number: 40000878

Project Title: CBPS SBCTC Statewide: Utility Submeters for Clean Buildings Act

## SubProjects

SubProject Number: 40000889

SubProject Title: Columbia Basin College: CBPS Utility Meters

Install utility grade submeters for the following buildings to measure and record building energy usage to calculate energy use target in compliance with the Clean Buildings Act:

### Tier 1B building:

- Lee R Thornton Ctr, (A00601), 1 electric, 1 gas meters

### Tier 1C buildings:

- Administration Building, (A09316), 1 electric, 1 gas meters
- Career and Technology, (A10443), 1 electric, 1 gas meters
- Hawk Union Building, (A09496), 1 electric, 1 gas, 1 BTU meters
- Social Sciences and World Languages Center, (A25158), 1 electric, 1 gas meters
- Student Recreation Center, (A26875), 1 electric meter
- Health Science Center, (A09278), 1 electric, 1 gas meters
- Wortman Medical Science Center, (A25159), 1 electric, 1 gas meters

### Tier 2 buildings:

- Business building, (A03600), 1 electric, 1 gas, 1 BTU meters
- Ch2Mhill Education Center, (A08572), 1 electric, 1 gas meters
- Library building, (A07081), 1 electric, 1 gas meters
- Performing Arts Building, (A08055), 1 electric, 1 gas, 1 BTU meters
- Richland Student Housing, (A26876), 1 electric, 1 gas meters
- SunHawk Hall, (A25310), 1 electric, 1 gas meters
- Vocational Tech building, (A03475), 1 electric, 1 gas meters

Starting Fiscal Year: 2024

Project Class: Preservation

Agency Priority: 1

### Project Summary

Installation of Tier 1 and Tier 2 building utility submeters

### Project Description

Install utility grade submeters for the following buildings to measure and record building energy usage to calculate energy use target in compliance with the Clean Buildings Act:

### Tier 1B building:

- Lynnwood Hall, (A04627), 1 electric, 1 BTU meters

### Tier 1C buildings:

- Brier Hall, (A03970), 1 electric, 1 BTU meters
- Mountlake Terrace Hall, (A09413), 1 electric, 1 BTU meters
- Mukilteo Hall, (A06234), 1 electric, 1 gas, 1 BTU meters
- Snohomish Hall, (A05555), 1 electric, 1 BTU meters
- Snoqualmie Hall, (A08635), 1 electric, 1 BTU meters

### Tier 2 buildings:

- Alderwood Hall, (A05756), 1 electric, 1 gas, 1 BTU meters
- Cedar Building, (A10031), 1 electric, 1 gas meters
- Gateway Hall, (A10107), 1 electric meter

699 - Community and Technical College System  
Capital Project Request

2023-25 Biennium

\*

Version: U1 SBCTC 2024 Supplemental Cap. Budget

Report Number: CBS002

Date Run: 9/8/2023 8:52AM

Project Number: 40000878

Project Title: CBPS SBCTC Statewide: Utility Submeters for Clean Buildings Act

**SubProjects**

SubProject Number: 40000890

SubProject Title: Edmonds College: CBPS Utility Meters

- Meadowdale Hall, (A06716), 1 electric, 1 BTU meters
- Seaview Gymnasium, (A04248), 1 electric, 1 gas, 1 BTU meters
- Woodway Hall, (A01301), 1 electric meter

Starting Fiscal Year: 2024

Project Class: Preservation

Agency Priority: 1

**Project Summary**

Installation of Tier 1 and Tier 2 building utility submeters

**Project Description**

Install utility grade submeters for the following buildings to measure and record building energy usage to calculate energy use target in compliance with the Clean Buildings Act:

Tier 1C buildings:

- Advanced Manufacturing and Training Center, (A21057), 1 electric, 2 BTU meters
- Gary Wolf Hall, (A03275), 1 electric, 2 BTU meters
- Liberty Hall, (A13569), 1 electric, 2 BTU meters
- Parks / Terrey, (A00051), 1 electric, 1 BTU meters
- Whitehorse Hall, (A01739), 1 electric, 1 gas, 2 BTU meters

Tier 2 buildings:

- Corporate and Continuing Ed Center, (A06897), 2 BTU meter
- Baker Hall, (A10077), 1 BTU meter
- Monte Cristo, (A10131), 1 electric, 1 steam, 1 BTU meters
- Olympus Hall, (A10814), 1 electric, 2 BTU meters
- Rainier Hall, (A10896), 1 electric, 2 BTU meters
- Shuksan, (A10553), 1 electric, 1 steam, 1 BTU meters
- Student Fitness Center, (A10560), 1 electric, 2 BTU meter
- Aviation Shop / Hanger, (A08614), 1 electric, 1 gas meters

Starting Fiscal Year: 2024

Project Class: Preservation

Agency Priority: 1

**Project Summary**

Installation of Tier 1 and Tier 2 building utility submeters

**Project Description**

Install utility grade submeters for the following buildings to measure and record building energy usage to calculate energy use target in compliance with the Clean Buildings Act:

Tier 1C building:

- Schermer Instructional, (A21240), 1 electric meter

Tier 2 buildings:

699 - Community and Technical College System  
Capital Project Request

2023-25 Biennium

\*

Version: U1 SBCTC 2024 Supplemental Cap. Budget

Report Number: CBS002

Date Run: 9/8/2023 8:52AM

Project Number: 40000878

Project Title: CBPS SBCTC Statewide: Utility Submeters for Clean Buildings Act

**SubProjects**

SubProject Number: 40000892

SubProject Title: Grays Harbor College: : CBPS Utility Meters

- Auto / Weld Technology, (A05800), 1 electric meter
- Voktek, (A09725), 1 electric, 1 gas meter

Starting Fiscal Year: 2024

Project Class: Preservation

Agency Priority: 1

**Project Summary**

Installation of Tier 1 and Tier 2 building utility submeters

**Project Description**

Install utility grade submeters for the following buildings to measure and record building energy usage to calculate energy use target in compliance with the Clean Buildings Act:

Tier 1C buildings:

- Holman Library, (A07353), 1 gas, 2 BTU meters
- Science Center, (A05561), 2 BTU meter
- Trades and Industry, (A21465), 1 gas, 1 BTU meters

Tier 2 buildings:

- Kent Campus, (A05349), 1 electric, 1 gas meters
- Kent Campus Phase 2, (A10362), 1 electric, 1 gas meters
- Bleha Performing Arts Center, (A05427), 1 gas, 1 BTU meters
- Rutkowski Learning Center, (A07189), 1 BTU meter
- Technology Center, (A05999), 2 BTU meters

Starting Fiscal Year: 2024

Project Class: Preservation

Agency Priority: 1

**Project Summary**

Installation of Tier 2 building utility submeters

**Project Description**

Install utility grade submeter for the following building to measure and record building energy usage to calculate energy use target in compliance with the Clean Buildings Act:

Tier 2 building:

- Technology Lab building, (A02946), 2 BTU meters

Starting Fiscal Year: 2024

Project Class: Preservation

Agency Priority: 1

**Project Summary**

Installation of Tier 1 building utility submeter



699 - Community and Technical College System  
Capital Project Request

2023-25 Biennium

\*

Version: U1 SBCTC 2024 Supplemental Cap. Budget

Report Number: CBS002

Date Run: 9/8/2023 8:52AM

Project Number: 40000878

Project Title: CBPS SBCTC Statewide: Utility Submeters for Clean Buildings Act

**SubProjects**

SubProject Number: 40000895

SubProject Title: Lake WA Institute of Technology: CBPS Utility Meters

**Project Description**

Install utility grade submeters for the following building to measure and record building energy usage to calculate energy use target in compliance with the Clean Building Act:

Tier 1C building:

- Allied Health building, (A10928), 1 electric meter

Starting Fiscal Year: 2024

Project Class: Preservation

Agency Priority: 1

**Project Summary**

Installation of Tier 1 and Tier 2 building utility submeters

**Project Description**

Install utility grade submeters for the following buildings to measure and record building energy usage to calculate energy use target in compliance with the Clean Buildings Act:

Tier 1C buildings:

- Don Talley building, (A06718), 1 electric, 1 gas meters
- Health & Science building, (A21351), 1 electric, 1 gas meters
- Rose Center for the Arts, (A02802), 1 electric, 1 gas meters

Tier 2 buildings:

- Alan Thompson Library, (A03674), 1 electric, 1 gas, 2 BTU meters
- Applied Arts, (A09067), 1 electric, 1 gas, 1 steam, 1 BTU meters
- Main Bldg Orig 9/1/1950, (A07038), 1 electric, 1 gas, 1 BTU meters
- Myklebust Gymnasium / Fitness Center, (A02399), 1 electric, 1 gas meters
- Student Center, (A08790), 1 electric, 1 gas meters
- Vocational, (A03581), 1 electric, 1 gas, 1 steam, 1 BTU meters

Starting Fiscal Year: 2024

Project Class: Preservation

Agency Priority: 1

**Project Summary**

Installation of Tier 1 and Tier 2 building utility submeters

**Project Description**

Install utility grade submeters for the following buildings to measure and record building energy usage to calculate energy use target in compliance with the Clean Buildings Act:

Tier 1B buildings:

- Arts and Sciences, (A03803), 1 BTU meter
- Instructional Building, (A04706), 1 electric, 1 gas, 1 BTU meters

699 - Community and Technical College System  
Capital Project Request

2023-25 Biennium

\*

Version: U1 SBCTC 2024 Supplemental Cap. Budget

Report Number: CBS002

Date Run: 9/8/2023 8:52AM

Project Number: 40000878

Project Title: CBPS SBCTC Statewide: Utility Submeters for Clean Buildings Act

**SubProjects**

SubProject Number: 40000897

SubProject Title: North Seattle College: CBPS Utility Meters

- College Center, (A02135), 1 BTU meter
- Health Sciences and Student Resources, (A21239), 1 electric, 1 BTU meters
- Library building, (A09018), 1 BTU meter

Tier 1C buildings:

- OCE&E, (A10701), 1 electric, 1 BTU meters

Tier 2 buildings:

- Education building, (A04435), 1 electric, 1 BTU meters
- Wellness Center, (A05052), 1 electric, 1 gas, 1 BTU meters

Starting Fiscal Year: 2024

Project Class: Preservation

Agency Priority: 1

**Project Summary**

Installation of Tier 1 and Tier 2 building utility submeters

**Project Description**

Install utility grade submeters for the following buildings to measure and record building energy usage to calculate energy use target in compliance with the Clean Buildings Act:

Tier 1C buildings:

- OC Bremerton, (A25541), 1 gas meter
- OC Bremerton, (A07734), 1 gas meter
- OC Bremerton (A07659), 1 gas meter
- OC Bremerton, (A03407), 1 gas meter
- OC Bremerton, (A08412), 1 gas meter

Tier 2 buildings:

- OC Bremerton, (A06195), 1 gas meter
- OC Bremerton, (A04881), 1 gas meter
- Olympic College Poulsbo, (A06616), 1 gas meter

Starting Fiscal Year: 2024

Project Class: Preservation

Agency Priority: 1

**Project Summary**

Installation of Tier 1 building utility submeters

**Project Description**

Install utility grade submeters for the following building to measure and record building energy usage to calculate energy use target in compliance with the Clean Buildings Act:

Tier 1C building:

- Science and Technology, (A08813), 1 gas, 1 BTU meters

699 - Community and Technical College System  
Capital Project Request

2023-25 Biennium

\*

Version: U1 SBCTC 2024 Supplemental Cap. Budget

Report Number: CBS002

Date Run: 9/8/2023 8:52AM

Project Number: 40000878

Project Title: CBPS SBCTC Statewide: Utility Submeters for Clean Buildings Act

**SubProjects**

SubProject Number: 40000899

SubProject Title: Peninsula College: CBPS Utility Meters

Starting Fiscal Year: 2024

Project Class: Preservation

Agency Priority: 1

**Project Summary**

Installation of Tier 1 and Tier 2 building utility submeters

**Project Description**

Install utility grade submeters for the following buildings to measure and record building energy usage to calculate energy use target in compliance with the Clean Buildings Act:

Tier 1C buildings:

- Rainier Building, (A01570), 1 electric meter
- Arts and Allied Health building, (A04354), 1 electric meter
- Brouillet Library / Science Bldg, (A03189), 2 electric meters
- College Center Building, (A06707), 1 electric meter

Tier 2 buildngs:

- Health Education Center, (A03199), 1 electric, 1 gas meters
- Olympic North Bldg, (A01116), 1 electric, 1 gas meters
- Olympic South Bldg, (A03250), 1 electric, 1 gas meters
- Gaspard Admin Bldg, (A03274), 1 electric meter

Starting Fiscal Year: 2024

Project Class: Preservation

Agency Priority: 1

**Project Summary**

Installation of Tier 1 and Tier 2 building utility submeters

**Project Description**

Install utility grade submeters for the following buildings to measure and record building energy usage to calculate energy use target in compliance with the Clean Buildings Act:

Tier 1C buildings:

- Business Technology, (A01938), 1 electric, 2 BTU meters
- Demoss Building, (A05747), 1 electric, 2 BTU meters
- Roberts Campus Center, (A04253), 1 electric, 2 BTU meters

Tier 2 buildings:

- Automotive Building K1, (A25160), 1 electric, 1 BTU meters
- Al Odem building, (A04594), 1 electric, 1 BTU meters
- Health Occupations, (A00284), 1 electric, 1 gas, 2 BTU meters
- McCormick, (A04666), 1 electric, 1 gas, 2 BTU meters
- Technology Resource Center, (A05103), 1 electric, 2 BTU meters

699 - Community and Technical College System  
Capital Project Request

2023-25 Biennium

\*

Version: U1 SBCTC 2024 Supplemental Cap. Budget

Report Number: CBS002

Date Run: 9/8/2023 8:52AM

Project Number: 40000878

Project Title: CBPS SBCTC Statewide: Utility Submeters for Clean Buildings Act

**SubProjects**

SubProject Number: 40000901

SubProject Title: Renton Technical College: CBPS Utility Meters

Starting Fiscal Year: 2024

Project Class: Preservation

Agency Priority: 1

**Project Summary**

Installation of Tier 1 and Tier 2 building utility submeters

**Project Description**

Install utility grade submeters for the following buildings to measure and record building energy usage to calculate energy use target in compliance with the Clean Buildings Act:

Tier 1A building:

- Broadway / Edison, (A02501), 1 electric, 1 steam meters

Tier 2 building:

- Broadway Performance Hall, (A02918), 1 steam meter

Starting Fiscal Year: 2024

Project Class: Preservation

Agency Priority: 1

**Project Summary**

Installation of Tier 1 and Tier 2 building utility submeters

**Project Description**

Install utility grade submeters for the following buildings to measure and record building energy usage to calculate energy use target in compliance with the Clean Buildings Act:

Tier 1C buildings:

- Foss, (A06886), 1 electric, 1 BTU meters

- Library, (A03204), 1 gas, 2 BTU meters

- Pagoda Union Building, (A02866), 2 BTU meters

Tier 2 buildings:

- Music, (A05615), 1 gas meter

- Physed, (A05877), 1 electric, 1 gas, 1 BTU meters

- Schlab, (A04022), 2 BTU meters

- Vocational Arts Facility, (A03730), 1 BTU meter

Starting Fiscal Year: 2024

Project Class: Preservation

Agency Priority: 1

**Project Summary**

Installation of Tier 1 and Tier 2 building utility submeters

**Project Description**

# 699 - Community and Technical College System Capital Project Request

2023-25 Biennium

\*

Version: U1 SBCTC 2024 Supplemental Cap. Budget

Report Number: CBS002

Date Run: 9/8/2023 8:52AM

Project Number: 40000878

Project Title: CBPS SBCTC Statewide: Utility Submeters for Clean Buildings Act

## SubProjects

SubProject Number: 40000904

SubProject Title: Skagit Valley College: CBPS Utility Meters

Install utility grade submeters for the following buildings to measure and record building energy usage to calculate energy use target in compliance with the Clean Buildings Act:

### Tier 1C buildings:

- Angst Hall, (A06053), 2 electric, 2 gas, 1 steam, 1 BTU meters
- Lewis Hall, (A21241), 1 electric, 1 steam, 1 BTU meters

### Tier 2 buildings:

- Ford Hall, (A05075), 1 electric, 1 steam, 1 BTU meters
- Gary Knutzen Cardinal Center, (A09143), 1 electric, 1 gas, 1 steam, 1 BTU meters
- Hodson Hall, (A09436), 1 electric, 1 gas, 1 steam, 1 BTU meters
- Norwood Cole Library, (A05680), 1 electric, 1 steam, 1 BTU meters
- Pavilion, (A08558), 1 electric, 1 gas, 1 steam, 1 BTU meters
- Reeves Hall, (A05238), 1 electric, 1 gas, 1 steam, 1 BTU meters
- Roberts Hall, (A09398), 2 electric, 1 gas, 1 steam, 1 BTU meters
- Oak Hall, (A03072), 1 electric, 1 gas meters
- Whidbey Old Main, (A06127), 1 electric, 1 gas meters

Starting Fiscal Year: 2024

Project Class: Preservation

Agency Priority: 1

### Project Summary

Installation of Tier 1 and Tier 2 building utility submeters

### Project Description

Install utility grade submeters for the following buildings to measure and record building energy usage to calculate energy use target in compliance with the Clean Buildings Act:

### Tier 1B building:

- Robert Smith, (A08446), 1 electric meter

### Tier 1C buildings:

- Rainier Hall, (A04220), 1 electric meter
- Cascade Hall, (A25244), 1 electric meter

### Tier 2 buildings:

- Bldg B, (A02010), 1 electric meter
- Bldg C, (A08339), 1 electric meter
- DUW Bldg A, (A02087), 1 electric meter
- Aviation, (A09552), 1 electric, 1 gas meters
- Culinary Arts Building, (A09411), 1 electric, 1 gas meters
- Jmbrockey Campus Center, (A07344), 1 electric meter
- Technology Center, (A01706), 1 electric, 1 gas meters

Starting Fiscal Year: 2024

Project Class: Preservation

Agency Priority: 1

**699 - Community and Technical College System  
Capital Project Request**

2023-25 Biennium

\*

Version: U1 SBCTC 2024 Supplemental Cap. Budget

Report Number: CBS002

Date Run: 9/8/2023 8:52AM

Project Number: 40000878

Project Title: CBPS SBCTC Statewide: Utility Submeters for Clean Buildings Act

**SubProjects**

SubProject Number: 40000907

SubProject Title: Spokane Community College: CBPS Utility Meters

**Project Summary**

Installation of Tier 1 and Tier 2 building utility submeters

**Project Description**

Install utility grade submeters for the following buildings to measure and record building energy usage to calculate energy use target in compliance with the Clean Buildings Act:

Tier 1A building:

- Classroom/Admin building, (A08547), 1 gas meter

Tier 1B building:

- Student Center, (A06460), 1 electric meter

Tier 1C building:

- Sports Complex, (A03206), 1 gas meter

Tier 2 buildings:

- Apprenticeship Center, (A10412), 1 electric, 1 gas meters
- Classroom/Admin building, (A06470), 1 electric, 1 gas meters
- Environmental Sciences Complex, (A09615), 1 electric, 1 gas meters
- Health Science Building, (A06777), 1 electric, 1 gas meters
- Student Services building, (A08828), 2 electric, 2 gas meters

**Location**

<b>City:</b> Aberdeen	<b>County:</b> Grays Harbor	<b>Legislative District:</b> 019
<b>City:</b> Auburn	<b>County:</b> King	<b>Legislative District:</b> 047
<b>City:</b> Bellevue	<b>County:</b> King	<b>Legislative District:</b> 041
<b>City:</b> Bellingham	<b>County:</b> Whatcom	<b>Legislative District:</b> 042
<b>City:</b> Bothell	<b>County:</b> Snohomish	<b>Legislative District:</b> 001
<b>City:</b> Bremerton	<b>County:</b> Kitsap	<b>Legislative District:</b> 026
<b>City:</b> Centralia	<b>County:</b> Lewis	<b>Legislative District:</b> 020
<b>City:</b> Des Moines	<b>County:</b> King	<b>Legislative District:</b> 033
<b>City:</b> Everett	<b>County:</b> Snohomish	<b>Legislative District:</b> 038
<b>City:</b> Kirkland	<b>County:</b> King	<b>Legislative District:</b> 045
<b>City:</b> Lakewood	<b>County:</b> Pierce	<b>Legislative District:</b> 028
<b>City:</b> Lakewood	<b>County:</b> Pierce	<b>Legislative District:</b> 029
<b>City:</b> Longview	<b>County:</b> Cowlitz	<b>Legislative District:</b> 019
<b>City:</b> Lynnwood	<b>County:</b> Snohomish	<b>Legislative District:</b> 032
<b>City:</b> Moses Lake	<b>County:</b> Grant	<b>Legislative District:</b> 013
<b>City:</b> Mount Vernon	<b>County:</b> Skagit	<b>Legislative District:</b> 040
<b>City:</b> Pasco	<b>County:</b> Franklin	<b>Legislative District:</b> 016
<b>City:</b> Port Angeles	<b>County:</b> Clallam	<b>Legislative District:</b> 024
<b>City:</b> Renton	<b>County:</b> King	<b>Legislative District:</b> 011

699 - Community and Technical College System  
Capital Project Request

2023-25 Biennium

\*

Version: U1 SBCTC 2024 Supplemental Cap. Budget

Report Number: CBS002

Date Run: 9/8/2023 8:52AM

Project Number: 40000878

Project Title: CBPS SBCTC Statewide: Utility Submeters for Clean Buildings Act

**SubProjects**

Location

SubProject Number: 40000906

SubProject Title: South Seattle College: CBPS Utility Meters

City: Seattle	County: King	Legislative District: 034
City: Seattle	County: King	Legislative District: 043
City: Seattle	County: King	Legislative District: 046
City: Shoreline	County: King	Legislative District: 032
City: Spokane	County: Spokane	Legislative District: 003
City: Spokane	County: Spokane	Legislative District: 006
City: Statewide	County: Statewide	Legislative District: 098
City: Tacoma	County: Pierce	Legislative District: 027
City: Tacoma	County: Pierce	Legislative District: 028
City: Vancouver	County: Clark	Legislative District: 049
City: Walla Walla	County: Walla Walla	Legislative District: 016
City: Wenatchee	County: Chelan	Legislative District: 012
City: Yakima	County: Yakima	Legislative District: 015

Project Type





699 - Community and Technical College System  
Capital Project Request

2023-25 Biennium

\*

Version: U1 SBCTC 2024 Supplemental Cap. Budget

Report Number: CBS002

Date Run: 9/8/2023 8:52AM

Project Number: 40000878

Project Title: CBPS SBCTC Statewide: Utility Submeters for Clean Buildings Act

**SubProjects**

SubProject Number: 40000879

SubProject Title: Bates Technical College: CBPS Utility Meters

**Growth Management impacts**

No Growth Management Acts impacts

**Growth Management impacts**

No Growth Management Act impacts

**Growth Management impacts**

No Growth Management Act impacts

**Growth Management impacts**

No Growth Management Act impacts

**Growth Management impacts**

No Growth Management Act impacts

**Growth Management impacts**

No Growth Management Act impacts

**Growth Management impacts**

No Growth Management Act impacts

**Growth Management impacts**

No Growth Management Act impacts

**Growth Management impacts**

No Growth Management Act impacts

**Growth Management impacts**

No Growth Management Act impacts

**Growth Management impacts**

No Growth Management Act impacts

**Growth Management impacts**

No Growth Management Act impacts

**Growth Management impacts**

No Growth Management Act impacts

**Growth Management impacts**

No Growth Management Act impacts

699 - Community and Technical College System  
Capital Project Request

2023-25 Biennium

\*

Version: U1 SBCTC 2024 Supplemental Cap. Budget

Report Number: CBS002

Date Run: 9/8/2023 8:52AM

Project Number: 40000878

Project Title: CBPS SBCTC Statewide: Utility Submeters for Clean Buildings Act

**SubProjects**

SubProject Number: 40000894

SubProject Title: Highline College: CBPS Utility Meters

**Growth Management impacts**

No Growth Management Act impacts

**Growth Management impacts**

No Growth Management Act impacts

**Growth Management impacts**

No Growth Management Act impacts

**Growth Management impacts**

No Growth Management Act impacts

**Growth Management impacts**

No Growth Management Act impacts

**Growth Management impacts**

No Growth Management Act impacts

**Growth Management impacts**

No Growth Management Act impacts

**Growth Management impacts**

No Growth Management Act impacts

**Growth Management impacts**

No Growth Management Act impacts

**Growth Management impacts**

No Growth Management Act impacts

**Growth Management impacts**

No Growth Management Act impacts

**Growth Management impacts**

No Growth Management Act impacts

**Growth Management impacts**

No Growth Management Act impacts

**Growth Management impacts**

No Growth Management Act impacts

699 - Community and Technical College System  
Capital Project Request

2023-25 Biennium

\*

Version: U1 SBCTC 2024 Supplemental Cap. Budget

Report Number: CBS002

Date Run: 9/8/2023 8:52AM

Project Number: 40000878

Project Title: CBPS SBCTC Statewide: Utility Submeters for Clean Buildings Act

**SubProjects**

SubProject Number: 40000909

SubProject Title: Tacoma Community College: CBPS Utility Meters

**Growth Management impacts**

No Growth Management Act impacts

**Growth Management impacts**

No Growth Management Act impacts

**Growth Management impacts**

No Growth Management Act impacts

**Growth Management impacts**

N/A

**Funding**

Acct Code	Account Title	Estimated Total	Expenditures		2023-25 Fiscal Period	
			Prior Biennium	Current Biennium	Reappropriations	New Appropriations
060-1	Comm/Tech Cap Proj A-State	170,000				170,000
	<b>Total</b>	<b>170,000</b>	<b>0</b>	<b>0</b>	<b>0</b>	<b>170,000</b>

**699 - Community and Technical College System  
Capital Project Request**

2023-25 Biennium

\*

Version: U1 SBCTC 2024 Supplemental Cap. Budget

Report Number: CBS002

Date Run: 9/8/2023 8:52AM

Project Number: 40000878

Project Title: CBPS SBCTC Statewide: Utility Submeters for Clean Buildings Act

**SubProjects**

SubProject Number: 40000879

SubProject Title: Bates Technical College: CBPS Utility Meters

<u>Funding</u>		<u>Expenditures</u>			<u>2023-25 Fiscal Period</u>	
<u>Acct Code</u>	<u>Account Title</u>	<u>Estimated Total</u>	<u>Prior Biennium</u>	<u>Current Biennium</u>	<u>Reappropriations</u>	<u>New Approps</u>
26C-1	Climate Commit Accou-State	247,000				247,000
26C-1	Climate Commit Accou-State	66,000				66,000
26C-1	Climate Commit Accou-State	71,000				71,000
26C-1	Climate Commit Accou-State	101,000				101,000
26C-1	Climate Commit Accou-State	129,000				129,000
26C-1	Climate Commit Accou-State	42,000				42,000
26C-1	Climate Commit Accou-State	1,306,000				1,306,000
26C-1	Climate Commit Accou-State	65,000				65,000
26C-1	Climate Commit Accou-State	527,000				527,000
26C-1	Climate Commit Accou-State	576,000				576,000
26C-1	Climate Commit Accou-State	615,000				615,000
26C-1	Climate Commit Accou-State	65,000				65,000
26C-1	Climate Commit Accou-State	307,000				307,000
26C-1	Climate Commit Accou-State	43,000				43,000
26C-1	Climate Commit Accou-State	37,000				37,000
26C-1	Climate Commit Accou-State	428,000				428,000
26C-1	Climate Commit Accou-State	271,000				271,000
26C-1	Climate Commit Accou-State	164,000				164,000
26C-1	Climate Commit Accou-State	42,000				42,000
26C-1	Climate Commit Accou-State	678,000				678,000
26C-1	Climate Commit Accou-State	423,000				423,000
26C-1	Climate Commit Accou-State	66,000				66,000
26C-1	Climate Commit Accou-State	271,000				271,000
26C-1	Climate Commit Accou-State	690,000				690,000
26C-1	Climate Commit Accou-State	171,000				171,000
26C-1	Climate Commit Accou-State	37,000				37,000
26C-1	Climate Commit Accou-State	259,000				259,000
26C-1	Climate Commit Accou-State	147,000				147,000
26C-1	Climate Commit Accou-State	71,000				71,000
26C-1	Climate Commit Accou-State	202,000				202,000
26C-1	Climate Commit Accou-State	257,000				257,000
<b>Total</b>		<b>8,374,000</b>	<b>0</b>	<b>0</b>	<b>0</b>	<b>8,374,000</b>

		<u>Future Fiscal Periods</u>			
		<u>2025-27</u>	<u>2027-29</u>	<u>2029-31</u>	<u>2031-33</u>
060-1	Comm/Tech Cap Proj A-State				
<b>Total</b>		<b>0</b>	<b>0</b>	<b>0</b>	<b>0</b>



699 - Community and Technical College System  
Capital Project Request

2023-25 Biennium

\*

Version: U1 SBCTC 2024 Supplemental Cap. Budget

Report Number: CBS002

Date Run: 9/8/2023 8:52AM

Project Number: 40000878

Project Title: CBPS SBCTC Statewide: Utility Submeters for Clean Buildings Act

**SubProjects**

SubProject Number: 40000903

SubProject Title: Shoreline Community College: CBPS Utility Meters

No Operating Impact

No Operating Impact

No Operating Impact

No Operating Impact

No Operating Impact

No Operating Impact

No Operating Impact

No Operating Impact

No Operating Impact

No Operating Impact

No Operating Impact

No Operating Impact

No Operating Impact

No Operating Impact

No Operating Impact

No Operating Impact

No Operating Impact

No Operating Impact

No Operating Impact

No Operating Impact

No Operating Impact

No Operating Impact

No Operating Impact

No Operating Impact

No Operating Impact

No Operating Impact

No Operating Impact

No Operating Impact

No Operating Impact

No Operating Impact

No Operating Impact

**699 - Community and Technical College System  
Capital Project Request**

2023-25 Biennium

\*

**Version:** U1 SBCTC 2024 Supplemental Cap. Budget

**Report Number:** CBS002

**Date Run:** 9/8/2023 8:52AM

**Project Number:** 40000878

**Project Title:** CBPS SBCTC Statewide: Utility Submeters for Clean Buildings Act

---

**SubProjects**

**SubProject Number:** 40000902

**SubProject Title:** Seattle Central College: CBPS Utility Meters

**No Operating Impact**

**Narrative**

Capital budget program support.

---

## Capital Project Request

2023-25 Biennium

\*

<u>Parameter</u>	<u>Entered As</u>	<u>Interpreted As</u>
Biennium	2023-25	2023-25
Agency	699	699
Version	U1-A	U1-A
Project Classification	*	All Project Classifications
Capital Project Number	40000878	40000878
Sort Order	Project Priority	Priority
Include Page Numbers	Y	Yes
For Word or Excel	N	N
User Group	Agency Budget	Agency Budget
User Id	*	All User Ids



CBPS SBCTC Statewide: Utility Submeters for Clean Buildings Act

#40000878

College	CBA Tier & Phase	UFI	Bldg. Name	Sum of Building Area
<b>Bates</b>	Tier 1B	A03217	Main Bldg. - Bldg. A	175,669
		A04062	East Annex - Bldg. C	101,620
	Tier 1C	A00368	Bldg. B	72,940
		A21454	Advanced Technology Building	51,629
	Tier 2	A00042	Bldg. C	41,760
		A01591	Bldg. A	31,356
		A05138	Bldg. D	47,040
<b>Bellevue</b>	Tier 1B	A06330	Bldg. E	44,557
		A25564	Housing	138,521
	Tier 1C	A27014	Student Success Center	71,462
	Tier 2	A10483	V Building	46,680
	<b>Bellingham</b>	Tier 1C	A03694	Morse Center
A10177			Campus Center	68,093
Tier 2		A00826	Building B	31,149
		A04501	Desmond Mcardle Center	21,542
<b>Big Bend</b>	Tier 1B	A09956	Haskell Center	30,742
		A26036	Workforce Education Center	122,900
	Tier 1C	A06637	Library/Atec	66,935
	Tier 2	A03411	Aircraft Hanger	30,251
		A07007	Airframe & Powerplant	27,592
<b>Cascadia</b>	Tier 1B	A03343	Cascadia I	111,500
<b>Centralia</b>	Tier 2	A01114	Transitional Services Building	28,420
		A06178	Technology Center	46,272
		A07720	Kirk Library	25,000
<b>Clark</b>	Tier 1B	A09419	Gaiser Hall	93,029
	Tier 1C	A04241	Clark College @ Wsuw	63,050
		A08429	Clark College @ Ctc	69,928
		A21460	Stem Building	69,998
		A00594	Scarpelli Hall	41,192
		A00631	Applied Arts IV	32,571
		A01067	Applied Arts II	21,881
		A03068	Pechanec Hall	26,567
	Tier 2	A04234	O'Connell Sport Center	46,910
		A04257	Baird Administration	23,949
		A05212	Bauer Hall	31,091
		A06742	Frost Arts Center	21,365
		A06744	Facilities Services	22,246
		A06964	Penguin Union Building	47,048
		A07270	T Building	30,609
		A08326	Cannell Library	48,250
		A08430	Applied Arts V	27,936
<b>Columbia Basin</b>		Tier 1B	A00601	Lee R Thornton Ctr
	Tier 1C	A08496	Hawk Union Building	67,695
		A09278	Health Science Center	67,010
		A09316	Administration Building	54,111
		A10443	Career & Technology	72,241
		A25158	SOCIAL SCIENCES AND WORLD LANGUAGES CENTER	66,724
		A25159	Wortman Medical Science Center	89,512
		A26875	Student Recreation Center	78,189
	Tier 2	A03475	Vocational Tech Building	45,368
		A03600	Business Building	22,500
		A07081	Library Building	37,895
		A08055	Performing Arts Building	37,170

		A08572	Ch2Mhill Education Ctr	35,000		
<b>Edmonds</b>	Tier 1B	A25310	SunHawk Hall	26,900		
		A04627	Lynnwood Hall	90,960		
	Tier 1C	A03970	Brier Hall	73,924		
		A05555	Snohomish Hall	50,400		
	Tier 2	A06234	Mukilteo Hall	67,279		
		A08635	Snoqualmie Hall	50,538		
		A09413	Mountlake Terrace Hall	60,401		
		A01301	Woodway Hall	25,782		
		A04248	Seavew Gymnasium	30,100		
		A05756	Alderwood Hall	22,050		
A06716		Meadowdale Hall	36,393			
A10031		Cedar Building	32,736			
A10107		Gateway Hall	32,239			
<b>Everett</b>		Tier 1C	A00051	Parks/Terrey	85,069	
	A01739		Whitehorse Hall	88,000		
	Tier 2	A03275	Gray Wolf Hall	77,000		
		A13569	Liberty Hall	88,000		
		A21057	Advanced Manufacturing And Training Center	71,212		
		A06897	Corporate And Continuing Ed Center	26,600		
		A08614	Avatn Shop/Hanger	31,200		
		A10077	Baker Hall	23,710		
		A10131	Monte Cristo	22,956		
		A10553	Shuksan	41,000		
<b>Grays Harbor</b>	Tier 1C	A10560	Student Fitness Center	49,800		
		A10814	Olympus Hall	23,612		
	Tier 2	A10896	Rainier Hall	34,719		
		A21240	Schermer Instructional	70,350		
		A05800	Auto/Weld Technology	21,750		
<b>Green River</b>	Tier 1C	A09725	Voktek	23,305		
		A05561	Science Center	81,258		
	Tier 2	A07353	(New) Holman Library	57,333		
		A21465	Trades And Industry	76,684		
		A05349	Kent Campus	22,192		
<b>Highline</b>	Tier 2	A05427	Bleha Prfrming Arts Cntr	20,178		
		A05999	Technology Center	32,700		
	Tier 1C	A07189	Rutkowski Learning Center	35,680		
		A10362	Kent Campus, Phase 2	43,526		
		A02946	Technology Lab Bldg	22,879		
<b>Lake Wa</b>	Tier 1C	A10928	Allied Health Building	83,700		
		A02802	Rose Center For The Arts	54,490		
<b>Lower Columbia</b>	Tier 1C	A06718	Don Talley Building	54,120		
		A21351	Health & Science Building	72,708		
	Tier 2	A02399	Myklebust Gymnasium/Fitness Center	34,654		
		A03581	Vocational	32,250		
		A03674	Alan Thompson Library	28,999		
		A07038	Main Bldg Orig.09/01/1950	39,914		
		A08790	Student Center	34,304		
		A09067	Applied Arts	26,636		
		<b>North Seattle</b>	Tier 1B	A02135	College Center	143,459
				A03803	Arts And Sciences	114,499
A04706	Instructional Building			139,666		
A09018	Library Building			92,459		
Tier 1C	A21239	Health Sciences And Student Resources	100,147			
	A10701	OCE&E	82,544			
	Tier 2	A04435	Education Building	43,557		
A05052		Wellness Center	48,032			
<b>Olympic</b>	Tier 1C	A03407	OC Bremerton	57,166		

		A07659	OC Bremerton	61,194
		A07734	OC Bremerton	70,302
		A08412	OC Bremerton	50,808
		A25541	OC Bremerton	75,000
	Tier 2	A04881	OC Bremerton	24,912
		A06195	OC Bremerton	42,918
		A06616	Olympic College Poulsbo	39,461
<b>Peninsula</b>	Tier 1C	A08813	Science & Technology	56,000
	Tier 2	A02004	Library Resource Center	26,680
		A04882	Theatre/Student Union	29,511
<b>Pierce</b>	Tier 1A	A08348	Cascade Bldg	247,595
	Tier 1C	A01570	Rainier Building	80,645
		A03189	Brouillet Library/Science Bldg	55,000
		A04354	Arts And Allied Health Building	61,597
		A06707	College Center Building	57,000
	Tier 2	A01116	Olympic North Bldg	25,160
		A03199	Health Education Cntr	45,539
		A03250	Olympic South Bldg	38,800
		A03274	Gaspard Admin. Bldg	41,500
<b>Renton</b>	Tier 1C	A01938	Business Technology	50,200
		A04253	Roberts Campus Center	50,364
		A05747	Demoss Building	61,963
	Tier 2	A00284	Health Occupations	46,435
		A04594	Al Odem Building	31,035
		A04666	Mccormick	26,183
		A05103	Technology Resource Cntr	46,597
		A25160	Automotive Bldg K1	25,234
<b>Seattle Central</b>	Tier 1A	A02501	Broadway/Edison	442,984
	Tier 2	A02918	Broadway Performance Hall	38,043
<b>Shoreline</b>	Tier 1C	A02866	Pagoda Union Building	60,076
		A03204	Library	52,680
		A06886	Foss	54,756
	Tier 2	A03730	Vocational Arts Facility	23,454
		A04022	Schlab	36,084
		A05615	Music	23,822
		A05877	Physed	46,656
<b>Skagit Valley</b>	Tier 1C	A06053	Angst Hall	67,942
		A21241	Lewis Hall	72,858
	Tier 2	A03072	Oak Hall	40,725
		A05075	Ford Hall	23,600
		A05238	Reeves Hall	21,970
		A05680	Norwood Cole Library	26,730
		A06127	Whidbey Old Main	27,342
		A08558	Pavilion	27,252
		A09143	Gary Knutzen Cardinal Center	27,558
		A09398	Roberts Hall	33,281
		A09436	Hodson Hall	31,312
<b>South Seattle</b>	Tier 1B	A08446	Robert Smith	95,488
	Tier 1C	A04220	Rainier Hall (Rah)	58,305
		A25244	CASCADE HALL	57,333
	Tier 2	A01706	Technology Center	36,449
		A02010	Bldg B	32,712
		A02087	Duw Building A	21,700
		A07344	Jmbrockey Campus Center	36,692
		A08339	Bldg C	23,814
		A09411	Culinary Arts Bldg (Cab)	22,435
		A09552	Aviation	36,900
<b>Spokane CC</b>	Tier 1A	A08547	Classroom / Admin Bldg	257,124

	Tier 1B	A06460	Student Center	98,151
	Tier 1C	A03206	Sports Complex	65,484
	Tier 2	A06470	Classroom / Admin Bldg	48,965
		A06777	Health Science Building	35,661
		A08828	Student Services Building	48,993
		A09615	Environmental Sciences Complex	35,668
		A10412	Apprenticeship Center	24,063
<b>Spokane Falls</b>	Tier 2	A01955	Science And Math Building	49,802
		A03711	Classroom / Admin Bldg -19	41,457
		A06764	Classroom / Admin Bldg -5	32,793
		A08600	Human Services Building	34,270
		A12985	Classroom / Admin Building	47,497
<b>Tacoma</b>	Tier 1C	A21056	H.C. Joe Harned Center For Health Careers	69,715
<b>Walla Walla</b>	Tier 1A	A02150	Main Building	226,348
	Tier 1C	A05479	Vocational Technical	55,819
	Tier 2	A00144	Dietrich Activity Center	38,500
		A02875	Water Environmental Sci	26,832
		A06271	Clarkston Main Building	44,896
		A07510	Technology Center	26,085
		A09551	Health Sci/Performing Art	36,164
<b>Wenatchee Valley</b>	Tier 1C	A06617	Wenatchi Hall	82,000
	Tier 2	A02712	Brown Library	33,756
		A04052	Batjer	40,784
<b>Yakima</b>	Tier 1C	A09012	Deccio Building	74,646
	Tier 2	A01980	Sherar Gym	35,699
		A03366	Prior Building	36,319
		A03561	Hopf Union Building	26,497
		A03586	Raymond Hall	28,255
<b>Grand Total</b>				<b>10,827,444</b>

699 - Community and Technical College System  
Capital Project Request

2023-25 Biennium

\*

Version: U1 SBCTC 2024 Supplemental Cap. Budget

Report Number: CBS002

Date Run: 9/4/2023 4:46PM

Project Number: 40000914

Project Title: HB 1390 Decarbonization Planning

**Description**

Starting Fiscal Year: 2024  
Project Class: Preservation  
Agency Priority: 2

**Project Summary**

The State Board for Community and Technical Colleges (SBCTC) requests \$724,000 to fulfill the planning requirements of HB 1390. Our understanding for implementing the 2023 legislation has changed since appropriations were made by the legislature and additional funding is needed to complete the planning required by the enacted bill.

**Project Description**

In 2019, the State Energy Performance Standard was established that requires the Department of Commerce (Commerce) to develop rules for energy performance standards for certain commercial buildings. In 2020, Commerce developed rules stating that energy efficiency measures (EEMs) for campus district heating and cooling systems is acceptable for compliance, as long as an energy audit demonstrates that the energy savings from the district system EEMs will be greater than the buildings' EEMs.

In 2023, the Legislature passed 2SHB 1390, requiring agencies with state-owned district energy systems that serve five or more buildings that total more than 100,000 square feet to create decarbonization plans that provide strategies for up to 15 years to decarbonize their physical plants. Decarbonization plans are required to include:

1. Mechanisms to replace fossil fuels, including a schedule for replacement;
2. An evaluation of possible options to partner with nearby sources and uses of waste heat and cooling;
3. An examination of opportunities to add buildings or other facilities to the system once it is decarbonized, a strategy to incentivize growth to a decarbonized system, and requirements for facilities joining the system; and,
4. An evaluation, prioritization, and scheduled plan for reducing energy use through conservation efforts both at the central plant and in the building connected to district energy systems that results in meeting the campus energy use intensity target.

Plans must be under development by June 30, 2024, and completed plans must be submitted to Commerce by June 30, 2025, for review and approval. Commerce may ask for plans to be revised and resubmitted if they do not meet the standards determined by Commerce. Commerce intends to develop rules regarding decarbonization plans during winter 2023-24.

Our understanding of the requirements for implementing the 2023 legislation has changed since appropriations were made by the Legislature. Meeting with the Department of Enterprise Services (DES) Energy Program staff, we now understand that planning must include the entire campus, not just the district energy plant. And, the initial appropriation was based on the premise that six colleges had state owned district energy systems, however, we have now determined there are ten. For these reasons, the current appropriation is insufficient to complete the plans required by the new law.

The State Board is collaborating with the DES Energy program and affected colleges to ensure that planning starts by June 2024 as required by the law, however, additional funding is needed to complete the full planning effort, covering ten different colleges.

The State Board is requesting \$724,000 in the supplemental budget for the implementation of 2SHB 1390.

**Location**

City: Statewide

County: Statewide

Legislative District: 098

**Project Type**

Special Programs

**699 - Community and Technical College System  
Capital Project Request**

2023-25 Biennium

\*

Version: U1 SBCTC 2024 Supplemental Cap. Budget

Report Number: CBS002

Date Run: 9/4/2023 4:46PM

Project Number: 40000914

Project Title: HB 1390 Decarbonization Planning

**Description**

Growth Management impacts  
N/A

**Funding**

Acct Code	Account Title	Estimated Total	Expenditures		2023-25 Fiscal Period	
			Prior Biennium	Current Biennium	Reappropriations	New Appropriations
26C-1	Climate Commit Accou-State	724,000				724,000
	<b>Total</b>	<b>724,000</b>	<b>0</b>	<b>0</b>	<b>0</b>	<b>724,000</b>
<b>Future Fiscal Periods</b>						
		<u>2025-27</u>	<u>2027-29</u>	<u>2029-31</u>	<u>2031-33</u>	
26C-1	Climate Commit Accou-State					
	<b>Total</b>	<b>0</b>	<b>0</b>	<b>0</b>	<b>0</b>	

**Operating Impacts**

No Operating Impact

**Narrative**

This planning effort is funded in the capital budget. Future operating impacts are unknown and at the discretion of the participating colleges if they choose to implement the completed plan.

## Capital Project Request

2023-25 Biennium

\*

<u>Parameter</u>	<u>Entered As</u>	<u>Interpreted As</u>
Biennium	2023-25	2023-25
Agency	699	699
Version	U1-A	U1-A
Project Classification	*	All Project Classifications
Capital Project Number	40000914	40000914
Sort Order	Project Priority	Priority
Include Page Numbers	Y	Yes
For Word or Excel	N	N
User Group	Agency Budget	Agency Budget
User Id	*	All User Ids

# 699 - Community and Technical College System Capital Project Request

2023-25 Biennium

\*

Version: U1 SBCTC 2024 Supplemental Cap. Budget

Report Number: CBS002

Date Run: 9/4/2023 4:37PM

Project Number: 40000106

Project Title: Lower Columbia: Center for Vocational and Transitional Studies

## Description

Starting Fiscal Year: 2024

Project Class: Preservation

Agency Priority: 4

### Project Summary

Replace 48,795 gross square feet (GSF) in the three oldest buildings on campus with a single new 46,267 GSF facility.

### Project Description

The following responses are excerpts from the project proposal prepared by the college for the community and technical college system competition for state funding. The project selection instructions and criteria are here - <https://www.sbctc.edu/colleges-staff/programs-services/capital-budget/capital-budget-development.aspx> The College's proposal is available upon request.

**1. Identify the problem or opportunity addressed. Why is the request a priority? (Numbers not served, students without classrooms, budget savings, safety improvements, history, and other backup necessary to understand the need for the request.) [See proposal section 1.1]**

Socioeconomic status and educational attainment in Cowlitz County are well below the state average. There is potential for change if a skilled workforce can be trained to support economic growth. The Cowlitz County Economic Development Council indicates that more than 30,000 manufacturing jobs need to be filled in the southwest Washington-Portland region as the existing workforce reaches retirement age over the next decade. Workforce Southwest Washington and the Columbia-Willamette Workforce Collaborative have launched an outreach campaign to make youth and adults aware of the career opportunities.

Lower Columbia College is poised to play a central role in preparing students for these jobs. The college's professional-technical programs prepare students for high demand occupations in machine trades, manufacturing, welding, and information technology. Basic skills/developmental education programs (transitional studies) provide the communications, computational and computer skills required to succeed. One-third of the college's students are enrolled in programs which prepare students for college, including Adult Basic Education (ABE), English as a Second Language (ESL), Integrated Basic Education and Skills Training (I-BEST) and General Education Development (GED.). The SBCTC Data Warehouse indicates that transitional studies accrued the most annual FTES at the college in 2016-17, extending a five-year trend.

However, the college's facilities for vocational education and transitional studies do not have adequate capacity to serve enrollment demand or program needs. The aging, deficient buildings are not safe for students or faculty to occupy. They prevent the college from fully serving the educational and economic needs of its community.

#### *Deficient Facilities-*

Machine trades, manufacturing, welding, information technology and transitional studies programs are housed in the wood-framed Vocational Building which was erected in 1960 as an auto shop. The 32,250 square foot structure is in failing condition and does not meet life safety standards. The welding labs were closed twice this past year due to air quality issues that exposed students and faculty to arsenic. It sits on liquefiable soils, has deficient roof-to-wall connections and could collapse in a seismic event. Fire resistance assemblies are not adequate for the size and use of the building. All of the mechanical and plumbing systems are beyond their service life. Some have failed completely. Electrical systems do not support contemporary equipment or technology.

Current facilities have inhibited the expansion of Computer Numerical Control router (CNC) equipment, especially in the welding program. The college's service area includes a significant number of custom manufacturers supporting the region's heavy industry. These manufacturers utilize both CNC equipment and manual machines in order to produce low volume,



# 699 - Community and Technical College System Capital Project Request

2023-25 Biennium

\*

Version: U1 SBCTC 2024 Supplemental Cap. Budget

Report Number: CBS002

Date Run: 9/4/2023 4:37PM

Project Number: 40000106

Project Title: Lower Columbia: Center for Vocational and Transitional Studies

## Description

highly specialized products. This requires Lower Columbia College's programs to maintain both manual and CNC equipment for its machining program and expand into CNC equipment to support its welding program. The welding shop and lab are too small for safe instruction and do not serve the curriculum. Existing facilities have make-shift electrical and networking capabilities and insufficient space availability that have severely limited the addition of equipment.

Lab layouts for programs in the Information Technology Meta Major are also inhibiting program development. The I.T. Hardware lab is a converted electronics lab that was established in the 1970s. It is not conducive to active learning, has inadequate instructional and equipment storage space, and cannot be reconfigured as technologies evolve. Instructional workstations limit class size cohort to 18 students. Information technology spaces cannot be monitored or secured. The 6,944 square foot Science Building was built in 1960. The 9,551 square foot Physical Science Building was built in 1971. Both are partially vacant because their spaces are not suitable for occupancy. Both sit on liquefiable soils, have inadequate shear walls and could collapse in a seismic event. Neither building is equipped with a fire sprinkler system. The 2015 Facility Condition Survey notes that the Science Building does not meet minimum health/safety requirements, has significant building system deterioration and indicates it had less than five years of remaining life. The Physical Science Building's plumbing and electrical systems are corroded from more than 44 years of exposure to chemical fumes. The labs were closed after being deemed unsafe to occupy.

### **2. What will the request produce or construct (i.e., design of a building, construction of additional space, etc.)? [See proposal section 1.2]**

The project will replace 48,795 gross square feet (GSF) in the three oldest buildings on campus with a single new 46,267 GSF facility.

### **3. How would the request address the problem or opportunity identified in question #1? What would be the result of not taking action? [See proposal sections 1.3]**

The project provides program-specific space for machining, welding, information technology, and transitional studies. It also provides general purpose classrooms that will be shared by these programs and utilized by the entire campus.

### **4. What alternatives were explored? Why was the recommended alternative chosen? [See proposal section 3.3]**

Renovation of Existing Buildings – The College considered the alternative of renovating the old Vocational, Science and Physical Science Buildings to serve its vocational and transitional studies programs. It was determined to be a poor expenditure of state funds for several reasons.

Do Nothing - If nothing is done the college will fall behind in its ability to serve the needs of its district in terms of providing employers with a workforce trained for high demand occupations and disadvantaged students with the opportunity to prepare for a college education.

The buildings continue to deteriorate and are unable to meet the needs of their programs. The welding lab had to be shut down for the fall 2017 quarter due to bad air quality. A qualified company will have to professionally clean the lab before students can return. The college must work with students on an individual basis to ensure that grades, financial aid, and program completion are not affected by the lab closure. With respect to student safety in welding the problem is cumulative: unacceptable air quality, workstations that are too small to be safe for instruction, and bad foundations.

At worst, these buildings represent a significant life safety hazard due to their poor structural condition, the liquefiable soils on campus and the wood-frame structure of the Vocational Building. An earthquake or a fire could render them permanently unusable. At that point the programs would have to be abandoned until a new building was constructed as an emergency measure. Significant state resources will need to be invested on deferred maintenance and repairs to keep the buildings operating at a minimal level which does not align with the needs of their high demand programs.

# 699 - Community and Technical College System Capital Project Request

2023-25 Biennium

\*

Version: U1 SBCTC 2024 Supplemental Cap. Budget

Report Number: CBS002

Date Run: 9/4/2023 4:37PM

Project Number: 40000106

Project Title: Lower Columbia: Center for Vocational and Transitional Studies

## Description

**5. Which clientele would be impacted by the budget request? Where and how many units would be added, people or communities served, etc. Be prepared to provide detailed cost backup. [See proposal section 2.5]**

The project will support an additional 31 full-time-equivalent students annually.

**6. Will non-state funds be used to complete the project? How much, what fund source, and could the request result in matching federal, state, local, or private funds? [See proposal section 1.6]**

The project is anticipated to be funded through general obligation bonds appropriated through the state's capital budget.

**7. Describe how the project supports the agency's strategic/master plans, contributes to statewide goal, or enables the agency to perform better. Reference feasibility studies, master plans, space programming, and other analyses as appropriate. [See proposal section 2.2]**

The project fulfills the goals of the college's Facility Master Plan. It is the college's first capital priority. It replaces aging, deficient, facilities by consolidating small existing buildings into a large facility to provide long term programmatic flexibility, improve operational efficiency and reduce maintenance costs. Co-locating programs allows programs to share resources such as active learning classrooms. Informal student study spaces create peer to peer engagement across multiple disciplines and make career pathways visible.

The facility will be in a highly visible location on axis with the campus pedestrian mall and immediately adjacent to the main campus entry, the Admissions Building and the Student Center Building. It will physically connect the college's vocational and preparatory programs with the rest of campus, improving access and giving students a sense of pride in their educational pursuits.

**8. Does the request include IT-related costs? (See the IT Appendix for guidance and follow directions to meet the OCIO review requirement.) [See Equipment tab of attached C100]**

The project has a budget for FFE that could include equipment that supports essential facility operational function and programs.

**9. If the project is linked to the Puget Sound Action Agenda, describe the impacts on the Action Agenda, including expenditure and FTE detail.**

While several of the state's community and technical colleges are in the Puget Sound region and all of the colleges are working to improve our environment, the colleges are not responsible for implementing elements of the Action Agenda for Puget Sound.

**10. Does this project contribute to statewide goals to reduce carbon pollution and/or improve energy efficiency? If yes, please elaborate. [See proposal section 7.4.2]**

The project includes the following best practices for Best Practices to Reduce Greenhouse Gas Emissions:

- a) Above code HVAC system efficiency
- b) Post occupancy commissioning
- c) Time of day and occupancy programming of lighting
- d) Efficient lighting
- e) Minimize building surface area for necessary floor area
- f) Roofing materials with high solar reflectance and reliability
- g) Orient building for natural light and reduced heating and cooling loads

**11. Equity impacts to under-represented communities (i.e., demographic, geographic, and economic groups that are**

# 699 - Community and Technical College System Capital Project Request

2023-25 Biennium

\*

Version: U1 SBCTC 2024 Supplemental Cap. Budget

Report Number: CBS002

Date Run: 9/4/2023 4:37PM

Project Number: 40000106

Project Title: Lower Columbia: Center for Vocational and Transitional Studies

## Description

### ***historically or currently underrepresented that may be affected by the policy, program and potential decision).***

This project supports current and future students with improved vocational and trade spaces and dedicated resources for Transitional Studies. It will allow LCC to expand enrollment in the fields of machining, manufacturing, welding and IT. These disciplines are in high demand by students historically underrepresented and who are seeking greater employment opportunities with higher salary possibilities.

**12. Populations benefiting from or burdened by the proposal** (i.e., program or policy expands or reduces opportunities and access for individuals who have historically been excluded or underserved; change in policies or practices that perpetuate racial disparities and/or institutional racism; and availability and accessibility of benefits and resources distributed to communities that need it).

Lower Columbia College serves the counties of Cowlitz and Wahkiakum. Both counties are not as racially diverse as other parts of the state. People of color makeup around 15% of the population. The school's demographics are nearly the same. However, nearly half of the students enrolled at LCC (46%) need financial aid and nearly the same percentage of the student body have dependents. In addition, one-third of the student body enroll in transition studies such as Adult Basic Education, English as a 2nd Language and I-Best which are typically programs aimed to support underrepresented populations.

**13.Strategies to mitigate unintended consequences** (i.e., program or policy integrates strategies to improve access for immigrants, refugees and under-represented people; culturally specific strategies to address the needs of Washingtonians; and perspectives involved or not involved in developing the proposal or in decision making).

Trade and vocational studies are the backbone to our community college system. LCC has a strong tradition of offering education and training in the trades and seeks to build upon this with a new building that will enhance the size and technology of its classrooms and labs supporting vocational programs along with more flexible space for collaboration. The consequences of not doing the project will add more barriers for those have been traditionally excluded from these opportunities.

### **14. Is there additional information you would like decision makers to know when evaluating this request?**

The preceding responses are excerpts from the project proposal prepared by the college for the community and technical college system competition for state funding. The project selection instructions and criteria are here - <https://www.sbctc.edu/colleges-staff/programs-services/capital-budget/capital-budget-development.aspx> The College's proposal is available upon request.

### **15. ESSB 5200 section 8035(6)(q) proviso concerning higher education institutions.**

The Lower Columbia Center for Vocational and Transitional Studies project has experienced cost escalation through increased costs on materials and labor due to inflation, delays in supply chain, discovery of an omission for demolition costs in prior cost estimates, and an unexpected requirement by the City of Longview to replace a 20" watermain that the college had designed the project to avoid. The college has taken several actions to control costs such as reducing the overall building by 8,400 square feet, removing a PV solar array, continuous value engineering, and seeking funding opportunities for equipment. The college lacks resources for additional money recovering from low enrollment and coming out of pandemic when local resources were expended and continues to pursue other funding opportunities such as applying for federal grants and fundraising. The college is also continuing to seek relief from the city's unplanned requirement to replace their water main.

## Location

City: Longview

County: Cowlitz

Legislative District: 019

## Project Type

Remodel/Renovate/Modernize (Major Projects)

**699 - Community and Technical College System  
Capital Project Request**

2023-25 Biennium

\*

Version: U1 SBCTC 2024 Supplemental Cap. Budget

Report Number: CBS002

Date Run: 9/4/2023 4:37PM

Project Number: 40000106

Project Title: Lower Columbia: Center for Vocational and Transitional Studies

**Description**

**Growth Management impacts**

No Growth Management Act impacts

**Funding**

Acct Code	Account Title	Estimated Total	Expenditures		2023-25 Fiscal Period	
			Prior Biennium	Current Biennium	Reappropriations	New Appropriations
057-1	State Bldg Constr-State	43,260,251		(443,749)		43,704,000
	<b>Total</b>	<b>43,260,251</b>	<b>0</b>	<b>(443,749)</b>	<b>0</b>	<b>43,704,000</b>
<b>Future Fiscal Periods</b>						
		<u>2025-27</u>	<u>2027-29</u>	<u>2029-31</u>	<u>2031-33</u>	
057-1	State Bldg Constr-State					
	<b>Total</b>	<b>0</b>	<b>0</b>	<b>0</b>	<b>0</b>	

**Operating Impacts**

No Operating Impact

# Capital Project Request

2023-25 Biennium

\*

<u>Parameter</u>	<u>Entered As</u>	<u>Interpreted As</u>
Biennium	2023-25	2023-25
Agency	699	699
Version	U1-A	U1-A
Project Classification	*	All Project Classifications
Capital Project Number	40000106	40000106
Sort Order	Project Priority	Priority
Include Page Numbers	Y	Yes
For Word or Excel	N	N
User Group	Agency Budget	Agency Budget
User Id	*	All User Ids

**STATE OF WASHINGTON**  
**AGENCY / INSTITUTION PROJECT COST SUMMARY**

*Updated May 2023*

Agency	Lower Columbia Community College	
Project Name	The Center for Vocational & Transitional Studies	
OFM Project Number	40000106	

**Contact Information**

Name	Darrell Jennings	
Phone Number	360-704-4382	
Email	<a href="mailto:djennings@sbctc.edu">djennings@sbctc.edu</a>	

**Statistics**

Gross Square Feet	49,707	MACC per Gross Square Foot	\$617
Usable Square Feet	32,590	Escalated MACC per Gross Square Foot	\$655
Alt Gross Unit of Measure			
Space Efficiency	65.6%	A/E Fee Class	B
Construction Type	College classroom facility	A/E Fee Percentage	6.70%
Remodel	No	Projected Life of Asset (Years)	50

**Additional Project Details**

Procurement Approach	DBB	Art Requirement Applies	Yes
Inflation Rate	3.33%	Higher Ed Institution	Yes
<a href="#">Sales Tax Rate %</a>	8.20%	Location Used for Tax Rate	1600 Maple St, Longview, WA 98632
Contingency Rate	5%		
Base Month (Estimate Date)	June-23	OFM UFI# (from FPMT, if available)	Demolish A09213 (Science), A03581 (Vocational), A01344 (Physical Science)
Project Administered By	DES		

**Schedule**

Predesign Start	October-21	Predesign End	March-22
Design Start	April-22	Design End	May-24
Construction Start	June-24	Construction End	June-26
Construction Duration	24 Months		

Green cells must be filled in by user

**Project Cost Summary**

Total Project	<b>\$44,440,038</b>	Total Project Escalated	<b>\$46,910,314</b>
		Rounded Escalated Total	<b>\$46,910,000</b>
Amount funded in Prior Biennia			<b>\$3,206,000</b>
<b>Amount in current Biennium</b>			<b>\$43,704,000</b>

Next Biennium  
Out Years

\$0  
\$0

**Acquisition**

<b>Acquisition Subtotal</b>	<b>\$0</b>	<b>Acquisition Subtotal Escalated</b>	<b>\$0</b>
-----------------------------	------------	---------------------------------------	------------

**Consultant Services**

Pre-design Services	\$220,836		
Design Phase Services	\$1,489,533		
Extra Services	\$1,259,934		
Other Services	\$1,130,252		
Design Services Contingency	\$205,028		
<b>Consultant Services Subtotal</b>	<b>\$4,305,583</b>	<b>Consultant Services Subtotal Escalated</b>	<b>\$4,396,116</b>

**Construction**

Maximum Allowable Construction Cost (MACC)	\$30,685,772	Maximum Allowable Construction Cost (MACC) Escalated	\$32,577,301
DBB Risk Contingencies	\$0		
DBB Management	\$0		
Owner Construction Contingency	\$1,534,289		\$1,638,314
Non-Taxable Items	\$0		\$0
Sales Tax	\$2,642,045	Sales Tax Escalated	\$2,805,680
<b>Construction Subtotal</b>	<b>\$34,862,106</b>	<b>Construction Subtotal Escalated</b>	<b>\$37,021,295</b>

**Equipment**

Equipment	\$1,403,820		
Sales Tax	\$115,113		
Non-Taxable Items	\$0		
<b>Equipment Subtotal</b>	<b>\$1,518,933</b>	<b>Equipment Subtotal Escalated</b>	<b>\$1,621,917</b>

**Artwork**

<b>Artwork Subtotal</b>	<b>\$233,385</b>	<b>Artwork Subtotal Escalated</b>	<b>\$233,385</b>
-------------------------	------------------	-----------------------------------	------------------

**Agency Project Administration**

Agency Project Administration Subtotal	\$0		
DES Additional Services Subtotal	\$0		
Other Project Admin Costs	\$0		
<b>Project Administration Subtotal</b>	<b>\$0</b>	<b>Project Administration Subtotal Escalated</b>	<b>\$0</b>

**Other Costs**

<b>Other Costs Subtotal</b>	<b>\$3,520,032</b>	<b>Other Costs Subtotal Escalated</b>	<b>\$3,637,601</b>
-----------------------------	--------------------	---------------------------------------	--------------------

### Project Cost Estimate

Total Project

**\$44,440,038**

Total Project Escalated

**\$46,910,314**

Rounded Escalated Total

**\$46,910,000**



## Funding Summary

	Project Cost (Escalated)	Funded in Prior Biennia	Current Biennium		
			2023-2025	2025-2027	Out Years
<b>Acquisition</b>					
Acquisition Subtotal	\$0	\$0	\$0		\$0
<b>Consultant Services</b>					
Consultant Services Subtotal	\$4,396,116	\$3,012,053	\$1,384,063		\$0
<b>Construction</b>					
Construction Subtotal	\$37,021,295	\$0	\$37,021,295		\$0
<b>Equipment</b>					
Equipment Subtotal	\$1,621,917	\$0	\$1,621,917		\$0
<b>Artwork</b>					
Artwork Subtotal	\$233,385	\$20,184	\$213,201		\$0
<b>Agency Project Administration</b>					
Project Administration Subtotal	\$0	\$0	\$0		\$0
<b>Other Costs</b>					
Other Costs Subtotal	\$3,637,601	\$174,061	\$3,463,540		\$0
<b>Project Cost Estimate</b>					
Total Project	\$46,910,314	\$3,206,298	\$43,704,016	\$0	\$0
	\$46,910,000	\$3,206,000	\$43,704,000	\$0	\$0
	Percentage requested as a new appropriation		93%		

**What is planned for the requested new appropriation? (Ex. Acquisition and design, phase 1 construction, etc. )**  
 This request will fully fund the construction phase of the project, including a new requirement by the City of Longview to replace a 20" water main located immediately adjacent to the site of the new building.  
 Insert Row Here

**What has been completed or is underway with a previous appropriation?**  
 The pre-design is complete and approved and the design phase is underway.  
 Insert Row Here

**What is planned with a future appropriation?**  
 No future appropriations are needed for this project.  
 Insert Row Here

## Cost Estimate Details

### Acquisition Costs

Item	Base Amount		Escalation Factor	Escalated Cost	Notes
Purchase/Lease					
Appraisal and Closing					
Right of Way					
Demolition					
Pre-Site Development					
Other					
Insert Row Here					
<b>ACQUISITION TOTAL</b>	<b>\$0</b>		<b>NA</b>	<b>\$0</b>	

Green cells must be filled in by user

## Cost Estimate Details

Consultant Services				
Item	Base Amount	Escalation Factor	Escalated Cost	Notes
<b>1) Pre-Schematic Design Services</b>				
Programming/Site Analysis				
Environmental Analysis				
Predesign Study	\$220,836			
<b>Sub TOTAL</b>	<b>\$220,836</b>	<b>1.0000</b>	<b>\$220,836</b>	Escalated to Design Start
<b>2) Construction Documents</b>				
<b>A/E Basic Design Services</b>	\$1,489,533			69% of A/E Basic Services
<b>Sub TOTAL</b>	<b>\$1,489,533</b>	<b>1.0000</b>	<b>\$1,489,534</b>	Escalated to Mid-Design
<b>3) Extra Services</b>				
Civil Design (Above Basic Svcs)	\$182,892			
Geotechnical Investigation	\$40,643			
Commissioning	\$30,482			
Site Survey	\$40,643			
Testing				
LEED Services	\$101,607			
Voice/Data Consultant	\$35,563			
Value Engineering	\$50,804			
Constructability Review	\$50,804			
Environmental Mitigation (EIS)				
Landscape Consultant	\$76,205			
Document Reproduction during design	\$5,081			
Acoustical Consultant	\$30,482			
Hazardous Materials Consultant	\$50,804			
VE Participation of Design Team	\$40,643			
Constructability Review Participation of Design Team	\$40,643			
Document repro for VE and CR	\$5,081			
CTE Lab Planning Consultant	\$127,008			
Roof & Envelope Consultant	\$20,322			
Audio/Visual, & CATV Consultant	\$35,563			
Stormwater Report (SWPP, NOI), & Permitting	\$20,322			
Energy Conservation Report (ELCCA)	\$25,402			
Interior Design Consultant	\$25,402			
Art Work Design Coordination	\$5,081			
Energy Modeling	\$10,161			

Signage Consultant	\$25,402			
Executive Order 13-03 (LCCA) for predesign and design	\$25,402			
SEPA Services	\$15,241			
PV Solar Array Design	\$10,161			
FF&E Coordination	\$10,161			
CTE Lab Equipment Selection/Procurement Coordination	\$40,643			
Specialized MEP System Design for CTE Lab Areas	\$60,964			
Special Renderings and Presentations	\$20,322			
<b>Sub TOTAL</b>	<b>\$1,259,934</b>	<b>1.0000</b>	<b>\$1,259,934</b>	Escalated to Mid-Design
<b>4) Other Services</b>				
<b>Bid/Construction/Closeout</b>	\$669,211			31% of A/E Basic Services
HVAC Balancing				
Staffing				
Post bid Commissioning and Training, and A/E Participation	\$102,000			
As-Built Documentation	\$40,800			
Construction Observation	\$102,000			
Roof/Envelope Inspection	\$20,400			
Advertising	\$2,041			
Geotechnical Construction Services	\$30,600			
Building Envelope (WAB) Testing	\$20,400			
Haz Mat Monitoring and Inspections	\$20,400			
Document Reproduction for base bid and construction	\$10,200			
Executive Order 13-03 (LCCA) after construction	\$10,200			
Construction Inspection and Materials Testing	\$102,000			
<b>Sub TOTAL</b>	<b>\$1,130,252</b>	<b>1.0678</b>	<b>\$1,206,883</b>	Escalated to Mid-Const.
<b>5) Design Services Contingency</b>				
Design Services Contingency	\$205,028			
<b>Sub TOTAL</b>	<b>\$205,028</b>	<b>1.0678</b>	<b>\$218,929</b>	Escalated to Mid-Const.
<b>CONSULTANT SERVICES TOTAL</b>	<b>\$4,305,583</b>		<b>\$4,396,116</b>	

Green cells must be filled in by user

## Cost Estimate Details

Construction Contracts					
Item	Base Amount		Escalation Factor	Escalated Cost	Notes
<b>1) Site Work</b>					
G10 - Site Preparation	\$744,518				
G20 - Site Improvements	\$1,382,546				
G30 - Site Mechanical Utilities	\$633,139				
G40 - Site Electrical Utilities	\$345,386				
G60 - Other Site Construction	\$0				
Demolition	\$1,096,248				
General Conditions	\$373,578				
Contractor's Overhead and Profit	\$630,187				
Subcontractor bonds 1%	\$287,656				
<b>Sub TOTAL</b>	<b>\$5,493,257</b>		<b>1.0334</b>	<b>\$5,676,733</b>	
<b>2) Related Project Costs</b>					
Offsite Improvements					
City Utilities Relocation					
Parking Mitigation					
Stormwater Retention/Detention					
<b>Sub TOTAL</b>	<b>\$0</b>		<b>1.0334</b>	<b>\$0</b>	
<b>3) Facility Construction</b>					
A10 - Foundations	\$1,490,053				
A20 - Basement Construction	\$0				
B10 - Superstructure	\$2,938,516				
B20 - Exterior Closure	\$5,799,184				
B30 - Roofing	\$908,002				
C10 - Interior Construction	\$1,303,049				
C20 - Stairs	\$194,502				
C30 - Interior Finishes	\$949,605				
D10 - Conveying	\$199,811				
D20 - Plumbing Systems	\$686,743				
D30 - HVAC Systems	\$3,667,616				
D40 - Fire Protection Systems	\$343,373				
D50 - Electrical Systems	\$2,594,811				
F10 - Special Construction	\$0				
F20 - Selective Demolition	\$0				
General Conditions	\$2,140,400				
E10 - Equipment	\$58,973				
E20 - Fixed Furnishings	\$269,768				
Contractor's Overhead and Profit	\$1,648,109				

Sub TOTAL	\$25,192,515	1.0678	\$26,900,568

<b>4) Maximum Allowable Construction Cost</b>			
MACC Sub TOTAL	\$30,685,772 \$617		\$32,577,301 \$655 per GSF

This Section is Intentionally Left Blank

<b>7) Owner Construction Contingency</b>			
Allowance for Change Orders	\$1,534,289		
Other			
Insert Row Here			
Sub TOTAL	\$1,534,289	1.0678	\$1,638,314

<b>8) Non-Taxable Items</b>			
Other			
Insert Row Here			
Sub TOTAL	\$0	1.0678	\$0

<b>9) Sales Tax</b>			
Sub TOTAL	\$2,642,045		\$2,805,680

<b>CONSTRUCTION CONTRACTS TOTAL</b>	<b>\$34,862,106</b>		<b>\$37,021,295</b>
-------------------------------------	---------------------	--	---------------------

Green cells must be filled in by user

## Cost Estimate Details

Equipment					
Item	Base Amount		Escalation Factor	Escalated Cost	Notes
<b>1) Equipment</b>					
E10 - Equipment	\$798,251				
E20 - Furnishings	\$605,569				
F10 - Special Construction					
<b>Sub TOTAL</b>	<b>\$1,403,820</b>		<b>1.0678</b>	<b>\$1,498,999</b>	
<b>2) Non Taxable Items</b>					
<b>Sub TOTAL</b>	<b>\$0</b>		<b>1.0678</b>	<b>\$0</b>	
<b>3) Sales Tax</b>					
<b>Sub TOTAL</b>	<b>\$115,113</b>			<b>\$122,918</b>	
<b>EQUIPMENT TOTAL</b>					
	<b>\$1,518,933</b>			<b>\$1,621,917</b>	

Green cells must be filled in by user

## Cost Estimate Details

Artwork					
Item	Base Amount		Escalation Factor	Escalated Cost	Notes
<b>1) Artwork</b>					
Project Artwork	\$0				0.5% of total project cost for new construction
Higher Ed Artwork	\$233,385				0.5% of total project cost for new and renewal construction
Other					
Insert Row Here					
<b>ARTWORK TOTAL</b>	<b>\$233,385</b>		<b>NA</b>	<b>\$233,385</b>	

Green cells must be filled in by user



## Cost Estimate Details

Project Management					
Item	Base Amount		Escalation Factor	Escalated Cost	Notes
<b>1) Agency Project Management</b>					
Agency Project Management	\$0				
Additional Services					
<i>Subtotal of Other</i>	<i>\$0</i>				
<b>PROJECT MANAGEMENT TOTAL</b>	<b>\$0</b>		<b>1.0678</b>	<b>\$0</b>	

Green cells must be filled in by user

## Cost Estimate Details

Other Costs					
Item	Base Amount		Escalation Factor	Escalated Cost	Notes
Mitigation Costs					
Hazardous Material Remediation/Removal					
Historic and Archeological Mitigation					
LEED Registration / Certification fees	\$4,955				
Relocate City of Longview water main	\$3,338,909				New city requirement.
Permit Review Fees	\$176,168				
<b>OTHER COSTS TOTAL</b>	<b>\$3,520,032</b>		<b>1.0334</b>	<b>\$3,637,601</b>	

Green cells must be filled in by user

**C-100(2023)**  
**Additional Notes**

**Tab A. Acquisition**

<i>Insert Row Here</i>

**Tab B. Consultant Services**

<i>Insert Row Here</i>

**Tab C. Construction Contracts**

<i>Insert Row Here</i>

**Tab D. Equipment**

<i>Insert Row Here</i>

**Tab E. Artwork**

<i>Insert Row Here</i>

**Tab F. Project Management**

<i>Insert Row Here</i>

**Tab G. Other Costs**

The City of Longview notified LCC on May 22, 2023 that it will require LCC to to replace/reroute the existing watermain with a new water main in the 15th Avenue ROW.
<i>Insert Row Here</i>

**SBCTC program updates for major projects included in a capital budget request**

**Project name:** Lower Columbia College: Center for Vocational and Transitional Studies

**OFM project number:** 40000106      **Legislative district(s):** 19

**Authority:**

- RCW 28B.50.140(2) gives college boards of trustee the authority and duty to create education and training programs that address local student and community needs.
- RCW 28B.50.090(1) gives the state board the power and duty to submit a single budget request for state capital funding.

**Procedure:**

The capital request includes a narrative that describes the program needs being addressed by the proposed project. Some narratives also identify the programs that need temporary accommodation during construction and how that need will be met.

Based upon the request, the Governor and members of the legislature develop expectations as to which programs will benefit from their decision to fund or continue funding a project. However, for a variety of reasons, the programs affected by a project may change between the time the project is initially proposed and the time construction is completed. The legislature has expressed interest in being kept abreast of program changes once a project has received state funding and until it is completed. There is also interest in knowing that the college has addressed stakeholder interests impacted by any changes.

To meet these needs, please update the following list of programs impacted by the capital project and provide documentation that the college board of trustees has approved any program changes in a public meeting. If there are no changes, please indicate that on the list also.

Requests for state appropriations will not be submitted to the Office of Financial Management for Governor or legislative consideration without this update.

Attach a copy of the college Board of Trustees resolution for every change.

**List of programs impacted by project at each milestone:**

<b>College Proposal</b>	<b>Design-phase funding request</b>	<b>Predesign to OFM</b>	<b>Const.-phase funding request</b>
<i>December 2017</i>	<i>September 2020</i>	<i>TBD</i>	TBD
Machine Trades	Machine Trades		
Manufacturing	Manufacturing		
Welding	Welding		
Information Technology	Information Technology		
Transitional Studies	Transitional Studies		

# 699 - Community and Technical College System Capital Project Request

2023-25 Biennium

\*

Version: U1 SBCTC 2024 Supplemental Cap. Budget

Report Number: CBS002

Date Run: 9/4/2023 4:34PM

Project Number: 40000108

Project Title: Columbia Basin: Performing Arts Building Replacement

## Description

Starting Fiscal Year: 2024

Project Class: Preservation

Agency Priority: 5

### Project Summary

The project will replace a 37,170 gross square feet (GSF) building with a new 58,668 GSF facility.

### Project Description

The following responses are excerpt from the project proposal prepared by the college for the community and technical college system competition for state funding. The project selection instructions and criteria are here - <https://www.sbctc.edu/colleges-staff/programs-services/capital-budget/capital-budget-development.aspx> The College's proposal is available upon request.

**1. Identify the problem or opportunity addressed. Why is the request a priority? (Numbers not served, students without classrooms, budget savings, safety improvements, history, and other backup necessary to understand the need for the request.) [See proposal section 1.1]**

Columbia Basin College (CBC) serves over 70,000 students in south-central Washington. For more than a decade, renovating or replacing the Performing Arts Center (P Building) has been the College's number one Facility Master Plan priority. For twenty years, the College has debated whether to renovate or replace the facility. Following detailed research into the construction of the building, and several cost estimating exercises for renovation, it has been determined that the most cost-effective solution is to replace the P Building.

By design, the P Building contains inadequacies that degrade the facility's function and make it inappropriate for instruction. The nature of its unique monolithic concrete structure makes renovation both monetarily and functionally prohibitive. Program spaces are inappropriately sized and insufficient. Almost 20% of the Art classes cannot be held in the building and are forced to be conducted elsewhere on campus where we struggle to provide an adequate learning environment. Classrooms are small, daylighting is poor, and dedicated storage space is non-existent. Some required spaces, such as performance and practice rooms, are not adequately provided for. Circulation within the building is awkward, confusing, and in certain areas, unsafe. The building is highly inefficient, with almost half the gross area utilized for building support and circulation. Instruction and student success is significantly hampered. There is no common space for faculty and student informal learning.

Students of today need access to facilities that deliver a modern and connected education. The P Building isolates programs and prohibits modern pedagogy. According to a recent article, "The Top Skills Career-Minded Students Need in Today's Digital Workforce", employers require incoming employees to think both critically and creatively to develop innovative solutions to problems. Doing so allows businesses to question what works, develop new ideas, and push beyond the status quo. Students of the arts are especially adept at thinking creatively, making them the ideal employees for businesses looking towards an innovative future.

**2. What will the request produce or construct (i.e., design of a building, construction of additional space, etc.)? [See proposal section 1.2]**

The project will replace 37,170 gross square feet (GSF) with a new 58,668 GSF facility.

**3. How would the request address the problem or opportunity identified in question #1? What would be the result of not taking action? [See proposal sections 1.3]**

The project addresses the Visual Arts, Performing Arts (Theater), Music, Multimedia, and Innovation Center programs. The facility will allow for program flexibility, adaptability, multiuse, collaboration, as well as interdisciplinary learning.

# 699 - Community and Technical College System Capital Project Request

2023-25 Biennium

\*

Version: U1 SBCTC 2024 Supplemental Cap. Budget

Report Number: CBS002

Date Run: 9/4/2023 4:34PM

Project Number: 40000108

Project Title: Columbia Basin: Performing Arts Building Replacement

## Description

### **4. What alternatives were explored? Why was the recommended alternative chosen? [See proposal section 3.3]**

We have looked at three alternatives to overcome the existing challenges of the P Building. These alternatives include:

Replace and Demolish Existing Building (Preferred Option) - Exploration of methods of renovating the existing facility have been discouraging, financially and from an operational standpoint. The existing facility is only 65% of the required size needed to adequately serve the Programs. This would necessitate an addition to the building, which would be a difficult endeavor. With those things in mind, the College feels that a full replacement of the facility is the preferred option to be funded, making the best argument from financial and educational perspectives. A subset for a Replacement project would be to fully replace the P Building yet attempt to preserve the existing structure through a third party who would take control of the building. The Washington Trust for Historic Preservation (WTHP) was contacted in this regard. The WTHP was interested in the building being preserved due to historical architectural significance. However, the WTHP is not able to purchase or control the building, as they are primarily a facilitator for such activities, and do not have resources to acquire real estate for preservation. This alternative should remain to be pursued with continued communication with WTHP as funding for the project and the design stages emerge in the future.

This direction would reduce the cost of demolition for the project; however, it would increase utilities and general site construction costs. It also creates a situation of third-party control of a facility within the campus boundaries.

Renovation and Addition - Renovation is not a cost-effective option. Not only are the exterior walls poured in place concrete, but all the interior walls and floors are concrete. To make the matter more difficult, the interior spaces are not an orthogonal geometry, but comprised of a series of angles, horizontally and vertically, making the spaces quite complex. As the building is truly monolithic, removal of the walls would require additional main structural support elsewhere, heavily increasing the cost of construction. Mechanical and electrical systems are cast into the concrete, making renovation impossible. There is inadequate interstitial space or vertical circulation, making the addition of new systems extremely difficult. It creates a large, complicated, and cost prohibitive engineering solution. It is the main reason that this building has had no substantial renovation in 47 years.

Do Nothing - If no action is taken, the P Building will continue to degrade and will continue to offer deficient instructional space. It will continue to act as a safety risk to those who utilize the space. Space will continue to be off limits to disabled faculty members and students who wish to reach the inaccessible faculty offices on the third floor. The building is not large enough and not efficient enough to house the needs of the programs within, and classes will increasingly need to be taught in other areas of the campus. Musical performances will continue to be held at local high schools. It is likely that participation in the Arts programs will decrease due to the many deficiencies in the building.

### **5. Which clientele would be impacted by the budget request? Where and how many units would be added, people or communities served, etc. Be prepared to provide detailed cost backup. [See proposal section 2.5]**

The project will support an additional 11.5 full-time-equivalent students annually.

### **6. Will non-state funds be used to complete the project? How much, what fund source, and could the request result in matching federal, state, local, or private funds? [See proposal section 1.6]**

The project is anticipated to be funded through general obligation bonds appropriated through the state's capital budget.

### **7. Describe how the project supports the agency's strategic/master plans, contributes to statewide goal, or enables the agency to perform better. Reference feasibility studies, master plans, space programming, and other analyses as appropriate. [See proposal section 2.2]**

The facility Master Plan identifies replacement of the P Building as the number one campus priority. The building's life

# 699 - Community and Technical College System Capital Project Request

2023-25 Biennium

\*

Version: U1 SBCTC 2024 Supplemental Cap. Budget

Report Number: CBS002

Date Run: 9/4/2023 4:34PM

Project Number: 40000108

Project Title: Columbia Basin: Performing Arts Building Replacement

## Description

expectancy was deemed less than five years when the master plan was written in 2012. Now, in 2022, the building is past due for replacement. Replacement of the P Building encompasses each goal of the Facility Master Plan.

Provide a safe, secure, accessible, and easily understood campus –

The current building is severely deficient in safety, security, and accessibility. It has numerous dark corners, lack of lighting, and lack of accessibility. The new building will create increased connectivity with the rest of campus, utilize 21st-century lighting, be accessible friendly, and provide an inviting rather than ominous presence, as is the current condition.

Create student-centered flexible, and adaptable environments that enhance instruction and learning –

The replacement project will provide modular and interactive space for staff and students, allowing adaptation to changing Arts related technologies. Classrooms and labs will be designed to allow for multi-use, flexibility, and collaboration. Spaces for music and theater will have improved acoustics and technology. Additionally, the new project will house expanded gallery and art studio space. New spaces will be formed that allow for various sizes of informal learning and collaboration.

Increase partnerships and funding –

The new Arts Center will be a gathering place for concerts, performances, gallery art experiences, industry-specific training opportunities and other events. Showcasing student work will also be a critical function of the Arts Center. The new building will increase community and business engagement on campus, along with greater collaboration with all levels of education. The availability of flexible spaces will provide opportunities for greater connectivity to the surrounding community and increased student engagement within the arts.

Surpass all sustainability measures –

The College strives to provide a campus that meets the needs of the present without compromising the ability of future generations to meet their own needs. The project will maximize solar opportunities, provide energy efficiency above the baseline, reduce interior and exterior water usage, minimize maintenance and operation expenses, and utilize natural daylighting. Sub-metering will be enabled to monitor and report sustainability efforts. Sustainability charrettes will be held at the earliest stages of design to customize the project to the College's priorities.

**8. Does the request include IT-related costs? (See the IT Appendix for guidance and follow directions to meet the OCIO review requirement.) [See Equipment tab of attached C100]**

The project has a budget for FFE that could include equipment that supports essential facility operational function and programs.

**9. If the project is linked to the Puget Sound Action Agenda, describe the impacts on the Action Agenda, including expenditure and FTE detail.**

While several of the state's community and technical colleges are in the Puget Sound region and all of the colleges are working to improve our environment, the colleges are not responsible for implementing elements of the Action Agenda for Puget Sound.

**10. Does this project contribute to statewide goals to reduce carbon pollution and/or improve energy efficiency? If yes, please elaborate. [See proposal section 7.4.2]**

The project includes the following best practices for Best Practices to Reduce Greenhouse Gas Emissions:

- a) Solar water heating
- b) Above code HVAC system efficiency
- c) Time of day and occupancy programming of lighting

# 699 - Community and Technical College System Capital Project Request

2023-25 Biennium

\*

Version: U1 SBCTC 2024 Supplemental Cap. Budget

Report Number: CBS002

Date Run: 9/4/2023 4:34PM

Project Number: 40000108

Project Title: Columbia Basin: Performing Arts Building Replacement

## Description

- d) Efficient lighting
- e) Minimize building surface area for necessary floor area
- f) Roofing materials with high solar reflectance and reliability
- g) Orient building for natural light and reduced heating and cooling loads
- h) Paving materials with high solar reflectance, enhanced water evaporation, or otherwise designed to remain cooler or require less lighting than conventional pavements
- i) Increase transportation choices – drive, walk, bike, or public transit

**11. Equity impacts to under-represented communities** (i.e., demographic, geographic, and economic groups that are historically or currently underrepresented that may be affected by the policy, program and potential decision).

Columbia Basin serves several counties in the southeast portion of Washington State enrolling students mostly from Franklin, Benton and Adams counties. The current demographics of the college is 45% non-white or student of color with 45% of the student body being of Hispanic/Latino descent. This project is replacing an aging performing arts center with a more accessible and efficient building allowing for more student participation in the performing arts from underrepresented groups both within the college and from within the Franklin County community.

**12. Populations benefiting from or burdened by the proposal** (i.e., program or policy expands or reduces opportunities and access for individuals who have historically been excluded or underserved; change in policies or practices that perpetuate racial disparities and/or institutional racism; and availability and accessibility of benefits and resources distributed to communities that need it).

The southeastern counties of Eastern Washington have a large Hispanic/Latino population and Franklin County is no exception with Hispanics making up over 50% of the population. This area is racially diverse. Columbia Basin College serves Franklin and Benton counties, and its programs are very important to the local communities. Performing Arts not only teaches students the arts but also showcases these endeavors to the local community by hosting concerts, festivals, and stage productions. For many underrepresented people and for the city of Pasco, this is a valuable expressive and visual arts outlet.

**13. Strategies to mitigate unintended consequences** (i.e., program or policy integrates strategies to improve access for immigrants, refugees and under-represented people; culturally specific strategies to address the needs of Washingtonians; and perspectives involved or not involved in developing the proposal or in decision making).

This project will expand access and involvement for our under-represented community and has no foreseeable unintended negative consequences. Should there be an unforeseen unintended negative consequence, we will continue to follow Governor Inslee's Executive Order 21-02, and "take all reasonable action to avoid, minimize or mitigate adverse effects to archeological and historic archaeological sites, historic buildings/structures, traditional cultural places, sacred sites or other cultural resources."

**14. Is there additional information you would like decision makers to know when evaluating this request?**

The preceding responses are excerpts from the project proposal prepared by the college for the community and technical college system competition for state funding. The project selection instructions and criteria are here - <https://www.sbctc.edu/colleges-staff/programs-services/capital-budget/capital-budget-development.aspx> The College's proposal is available upon request.

### Location

City: Pasco

County: Franklin

Legislative District: 016

### Project Type

Remodel/Renovate/Modernize (Major Projects)



**699 - Community and Technical College System  
Capital Project Request**

2023-25 Biennium

\*

Version: U1 SBCTC 2024 Supplemental Cap. Budget

Report Number: CBS002

Date Run: 9/4/2023 4:34PM

Project Number: 40000108

Project Title: Columbia Basin: Performing Arts Building Replacement

**Description**

**Growth Management impacts**

No growth management impacts are anticipated.

**Funding**

Acct Code	Account Title	Estimated Total	Expenditures		2023-25 Fiscal Period	
			Prior Biennium	Current Biennium	Reapprops	New Approps
057-1	State Bldg Constr-State	47,876,000				47,876,000
	<b>Total</b>	<b>47,876,000</b>	<b>0</b>	<b>0</b>	<b>0</b>	<b>47,876,000</b>
<b>Future Fiscal Periods</b>						
		<u>2025-27</u>	<u>2027-29</u>	<u>2029-31</u>	<u>2031-33</u>	
057-1	State Bldg Constr-State					
	<b>Total</b>	<b>0</b>	<b>0</b>	<b>0</b>	<b>0</b>	

**Operating Impacts**

**Total one time start up and ongoing operating costs**

Acct Code	Account Title	FY 2024	FY 2025	FY 2026	FY 2027	FY 2028
FTE	Full Time Employee	0.5	1.6	1.6	1.6	1.6
001-1	General Fund-State	62,488	187,463	187,463	187,463	187,463
	<b>Total</b>	<b>62,488</b>	<b>187,463</b>	<b>187,463</b>	<b>187,463</b>	<b>187,463</b>

**Narrative**

21,498 net new square feet at \$8.72/Net-new-GSF/year starting at the end of construction (Mar-26). And, FTE equals the operating cost divided by \$120,000.

## Capital Project Request

2023-25 Biennium

\*

<u>Parameter</u>	<u>Entered As</u>	<u>Interpreted As</u>
Biennium	2023-25	2023-25
Agency	699	699
Version	U1-A	U1-A
Project Classification	*	All Project Classifications
Capital Project Number	40000108	40000108
Sort Order	Project Priority	Priority
Include Page Numbers	Y	Yes
For Word or Excel	N	N
User Group	Agency Budget	Agency Budget
User Id	*	All User Ids

**STATE OF WASHINGTON**  
**AGENCY / INSTITUTION PROJECT COST SUMMARY**

*Updated May 2023*

Agency	Columbia Basin College
Project Name	Performing Arts Building Replacement
OFM Project Number	40000108

**Contact Information**

Name	Darrell Jennings
Phone Number	360-704-4382
Email	<a href="mailto:djennings@sbctc.edu">djennings@sbctc.edu</a>

**Statistics**

Gross Square Feet	58,668	MACC per Gross Square Foot	\$548
Usable Square Feet	42,924	Escalated MACC per Gross Square Foot	\$592
Alt Gross Unit of Measure			
Space Efficiency	73.2%	A/E Fee Class	B
Construction Type	College classroom facility	A/E Fee Percentage	6.65%
Remodel	No	Projected Life of Asset (Years)	50

**Additional Project Details**

Procurement Approach	DB-Progressive	Art Requirement Applies	Yes
Inflation Rate	3.33%	Higher Ed Institution	Yes
<a href="#">Sales Tax Rate %</a>	8.90%	Location Used for Tax Rate	2600 N. 20th Ave, Pasco WA 99301
Contingency Rate	5%		
Base Month (Estimate Date)	June-23	OFM UFI# (from FPMT, if available)	to demolish A08055 (P Building)
Project Administered By	DES		

**Schedule**

Predesign Start	May-24	Predesign End	November-24
Design Start	December-24	Design End	October-26
Construction Start	December-24	Construction End	October-26
Construction Duration	22 Months		

Green cells must be filled in by user

**Project Cost Summary**

Total Project	\$44,325,642	Total Project Escalated	\$47,875,743
		Rounded Escalated Total	\$47,876,000
Amount funded in Prior Biennia			\$0
<b>Amount in current Biennium</b>			<b>\$47,876,000</b>
Next Biennium			\$0
Out Years			\$0

Acquisition			
Acquisition Subtotal	\$0	Acquisition Subtotal Escalated	\$0

Consultant Services			
Predesign Services	\$250,681		
Design Phase Services	\$1,548,746		
Extra Services	\$806,352		
Other Services	\$863,320		
Design Services Contingency	\$173,455		
<b>Consultant Services Subtotal</b>	<b>\$3,642,554</b>	<b>Consultant Services Subtotal Escalated</b>	<b>\$3,935,046</b>

Construction			
Maximum Allowable Construction Cost (MACC)	\$32,145,493	Maximum Allowable Construction Cost (MACC) Escalated	\$34,729,107
DB-Progressive Risk Contingencies	\$0		
DB-Progressive Management	\$0		
Owner Construction Contingency	\$1,607,275		\$1,739,875
Non-Taxable Items	\$0		\$0
Sales Tax	\$3,003,996	Sales Tax Escalated	\$3,245,739
<b>Construction Subtotal</b>	<b>\$36,756,764</b>	<b>Construction Subtotal Escalated</b>	<b>\$39,714,721</b>

Equipment			
Equipment	\$3,254,118		
Sales Tax	\$289,617		
Non-Taxable Items	\$0		
<b>Equipment Subtotal</b>	<b>\$3,543,735</b>	<b>Equipment Subtotal Escalated</b>	<b>\$3,836,093</b>

Artwork			
Artwork Subtotal	\$238,188	Artwork Subtotal Escalated	\$238,188

Agency Project Administration			
Agency Project Administration Subtotal	\$0		
DES Additional Services Subtotal	\$0		
Other Project Admin Costs	\$0		
<b>Project Administration Subtotal</b>	<b>\$0</b>	<b>Project Administration Subtotal Escalated</b>	<b>\$0</b>

Other Costs			
Other Costs Subtotal	\$144,402	Other Costs Subtotal Escalated	\$151,695

**Project Cost Estimate**

Total Project

**\$44,325,642**

Total Project Escalated

**\$47,875,743**

Rounded Escalated Total

**\$47,876,000**

## Funding Summary

	Project Cost (Escalated)	Funded in Prior Biennia	Current Biennium		
			2023-2025	2025-2027	Out Years
<b>Acquisition</b>					
Acquisition Subtotal	\$0		\$0		\$0
<b>Consultant Services</b>					
Consultant Services Subtotal	\$3,935,046		\$3,935,046		\$0
<b>Construction</b>					
Construction Subtotal	\$39,714,721		\$39,714,721		\$0
<b>Equipment</b>					
Equipment Subtotal	\$3,836,093		\$3,836,093		\$0
<b>Artwork</b>					
Artwork Subtotal	\$238,188		\$238,188		\$0
<b>Agency Project Administration</b>					
Project Administration Subtotal	\$0		\$0		\$0
<b>Other Costs</b>					
Other Costs Subtotal	\$151,695		\$151,695		\$0
<b>Project Cost Estimate</b>					
Total Project	\$47,875,743	\$0	\$47,875,743	\$0	\$0
	\$47,876,000	\$0	\$47,876,000	\$0	\$0
Percentage requested as a new appropriation			100%		

**What is planned for the requested new appropriation? (Ex. Acquisition and design, phase 1 construction, etc. )**  
 Consistent with SSB 5651 Sec 7012, this appropriation request is for all project phases, predesign through construction.

*Insert Row Here*

**What has been completed or is underway with a previous appropriation?**  
 N/A

*Insert Row Here*

**What is planned with a future appropriation?**  
 Assuming full funding, there are no future appropriations needed.

*Insert Row Here*

## Cost Estimate Details

Acquisition Costs					
Item	Base Amount		Escalation Factor	Escalated Cost	Notes
Purchase/Lease					
Appraisal and Closing					
Right of Way					
Demolition					
Pre-Site Development					
Other					
Insert Row Here					
<b>ACQUISITION TOTAL</b>	<b>\$0</b>		<b>NA</b>	<b>\$0</b>	

Green cells must be filled in by user

## Cost Estimate Details

Consultant Services				
Item	Base Amount	Escalation Factor	Escalated Cost	Notes
<b>1) Pre-Schematic Design Services</b>				
Programming/Site Analysis				
Environmental Analysis				
Predesign Study	\$221,800			
Mitigation Planning DAHP	\$28,881			
<b>Sub TOTAL</b>	<b>\$250,681</b>	<b>1.0505</b>	<b>\$263,341</b>	Escalated to Design Start
<b>2) Construction Documents</b>				
<b>A/E Basic Design Services</b>	\$1,548,746			69% of A/E Basic Services
Other				
Insert Row Here				
<b>Sub TOTAL</b>	<b>\$1,548,746</b>	<b>1.0825</b>	<b>\$1,676,518</b>	Escalated to Mid-Design
<b>3) Extra Services</b>				
Civil Design (Above Basic Svcs)	\$75,090			
Geotechnical Investigation	\$13,863			
Commissioning	\$17,330			
Site Survey	\$17,330			
Testing	\$28,881			
LEED Services	\$103,969			
Voice/Data Consultant	\$20,794			
Value Engineering	\$69,313			
Constructability Review	\$103,969			
Environmental Mitigation (EIS)				
Landscape Consultant	\$17,330			
Renderings/Presentations	\$51,985			
Acoustical Consultant	\$51,985			
Cost Consultant	\$57,762			
Lighting and A/V Consultant	\$43,899			
Theatre Design Consultant	\$46,209			
Energy Conservation Model (ELCCA)	\$57,762			
Interior Design	\$28,881			
<b>Sub TOTAL</b>	<b>\$806,352</b>	<b>1.0825</b>	<b>\$872,877</b>	Escalated to Mid-Design
<b>4) Other Services</b>				
<b>Bid/Construction/Closeout</b>	\$695,813			31% of A/E Basic Services
HVAC Balancing	\$51,985			
Staffing				
Commissioning	\$69,313			
Testing	\$46,209			
<b>Sub TOTAL</b>	<b>\$863,320</b>	<b>1.0825</b>	<b>\$934,545</b>	Escalated to Mid-Const.



**5) Design Services Contingency**

Design Services Contingency	\$173,455			
Other				
Insert Row Here				
<b>Sub TOTAL</b>	<b>\$173,455</b>	<b>1.0825</b>	<b>\$187,765</b>	Escalated to Mid-Const.
<b>CONSULTANT SERVICES TOTAL</b>	<b>\$3,642,554</b>		<b>\$3,935,046</b>	

Green cells must be filled in by user

## Cost Estimate Details

Construction Contracts				
Item	Base Amount	Escalation Factor	Escalated Cost	Notes
<b>1) Site Work</b>				
G10 - Site Preparation	\$475,132			
G20 - Site Improvements	\$784,471			
G30 - Site Mechanical Utilities	\$525,664			
G40 - Site Electrical Utilities	\$250,860			
G60 - Other Site Construction				
<b>Sub TOTAL</b>	<b>\$2,036,127</b>	<b>1.0505</b>	<b>\$2,138,952</b>	
<b>2) Related Project Costs</b>				
Offsite Improvements				
City Utilities Relocation				
Parking Mitigation				
Stormwater Retention/Detention	\$101,092			
<b>Sub TOTAL</b>	<b>\$101,092</b>	<b>1.0505</b>	<b>\$106,198</b>	
<b>3) Facility Construction</b>				
A10 - Foundations	\$854,577			
A20 - Basement Construction				
B10 - Superstructure	\$2,683,899			
B20 - Exterior Closure	\$3,667,549			
B30 - Roofing	\$845,673			
C10 - Interior Construction	\$4,116,200			
C20 - Stairs	\$289,311			
C30 - Interior Finishes	\$2,376,787			
D10 - Conveying	\$178,038			
D20 - Plumbing Systems	\$1,468,800			
D30 - HVAC Systems	\$4,642,296			
D40 - Fire Protection Systems	\$721,049			
D50 - Electrical Systems	\$5,029,525			
F10 - Special Construction				
F20 - Selective Demolition	\$1,466,370			
General Conditions	\$1,668,200			
<b>Sub TOTAL</b>	<b>\$30,008,274</b>	<b>1.0825</b>	<b>\$32,483,957</b>	
<b>4) Maximum Allowable Construction Cost</b>				
<b>MACC Sub TOTAL</b>	<b>\$32,145,493</b>		<b>\$34,729,107</b>	
	\$548		\$592 per GSF	

This Section is Intentionally Left Blank

**7) Owner Construction Contingency**

Allowance for Change Orders	\$1,607,275		
Other			
Insert Row Here			
<b>Sub TOTAL</b>	<b>\$1,607,275</b>	<b>1.0825</b>	<b>\$1,739,875</b>

**8) Non-Taxable Items**

Other			
Insert Row Here			
<b>Sub TOTAL</b>	<b>\$0</b>	<b>1.0825</b>	<b>\$0</b>

**9) Sales Tax**

<b>Sub TOTAL</b>	<b>\$3,003,996</b>		<b>\$3,245,739</b>
------------------	--------------------	--	--------------------

<b>CONSTRUCTION CONTRACTS TOTAL</b>	<b>\$36,756,764</b>		<b>\$39,714,721</b>
-------------------------------------	---------------------	--	---------------------

Green cells must be filled in by user

## Cost Estimate Details

Equipment					
Item	Base Amount		Escalation Factor	Escalated Cost	Notes
<b>1) Equipment</b>					
E10 - Equipment	\$1,660,449				
E20 - Furnishings	\$1,091,153				
F10 - Special Construction					
A/V Systems and Equipment	\$144,402				
Theatre Stage Equipment	\$358,114				
<b>Sub TOTAL</b>	<b>\$3,254,118</b>		<b>1.0825</b>	<b>\$3,522,583</b>	
<b>2) Non Taxable Items</b>					
Other					
Insert Row Here					
<b>Sub TOTAL</b>	<b>\$0</b>		<b>1.0825</b>	<b>\$0</b>	
<b>3) Sales Tax</b>					
<b>Sub TOTAL</b>	<b>\$289,617</b>			<b>\$313,510</b>	
<b>EQUIPMENT TOTAL</b>					
<b>EQUIPMENT TOTAL</b>	<b>\$3,543,735</b>			<b>\$3,836,093</b>	

Green cells must be filled in by user

## Cost Estimate Details

Artwork					
Item	Base Amount		Escalation Factor	Escalated Cost	Notes
<b>1) Artwork</b>					
Project Artwork	\$0				0.5% of total project cost for new construction
Higher Ed Artwork	\$238,188				0.5% of total project cost for new and renewal construction
Other					
Insert Row Here					
<b>ARTWORK TOTAL</b>	<b>\$238,188</b>		<b>NA</b>	<b>\$238,188</b>	

Green cells must be filled in by user

## Cost Estimate Details

Project Management					
Item	Base Amount		Escalation Factor	Escalated Cost	Notes
<b>1) Agency Project Management</b>					
Agency Project Management	\$0				
Additional Services					
Other					
Insert Row Here					
<i>Subtotal of Other</i>	<i>\$0</i>				
<b>PROJECT MANAGEMENT TOTAL</b>	<b>\$0</b>		<b>1.0825</b>	<b>\$0</b>	

Green cells must be filled in by user

## Cost Estimate Details

Other Costs					
Item	Base Amount		Escalation Factor	Escalated Cost	Notes
Mitigation Costs					
Hazardous Material Remediation/Removal					
Historic and Archeological Mitigation	\$144,402				
Other					
Insert Row Here					
<b>OTHER COSTS TOTAL</b>	<b>\$144,402</b>		<b>1.0505</b>	<b>\$151,695</b>	

Green cells must be filled in by user

**C-100(2023)**  
**Additional Notes**

**Tab A. Acquisition**

<i>Insert Row Here</i>

**Tab B. Consultant Services**

<i>Insert Row Here</i>

**Tab C. Construction Contracts**

<i>Insert Row Here</i>

**Tab D. Equipment**

<i>Insert Row Here</i>

**Tab E. Artwork**

<i>Insert Row Here</i>

**Tab F. Project Management**

<i>Insert Row Here</i>

**Tab G. Other Costs**

<i>Insert Row Here</i>



**SBCTC program updates for major projects included in a capital budget request**

**Project name:** Columbia Basin College – Performing Arts Building Replacement

**OFM project number:** 40000108      **Legislative district(s):** 8, 16

**Authority:**

- RCW 28B.50.140(2) gives college boards of trustee the authority and duty to create education and training programs that address local student and community needs.
- RCW 28B.50.090(1) gives the state board the power and duty to submit a single budget request for state capital funding.

**Procedure:**

The capital request includes a narrative that describes the program needs being addressed by the proposed project. Some narratives also identify the programs that need temporary accommodation during construction and how that need will be met.

Based upon the request, the Governor and members of the legislature develop expectations as to which programs will benefit from their decision to fund or continue funding a project. However, for a variety of reasons, the programs affected by a project may change between the time the project is initially proposed and the time construction is completed. The legislature has expressed interest in being kept abreast of program changes once a project has received state funding and until it is completed. There is also interest in knowing that the college has addressed stakeholder interests impacted by any changes.

To meet these needs, please update the following list of programs impacted by the capital project and provide documentation that the college board of trustees has approved any program changes in a public meeting. If there are no changes, please indicate that on the list also.

Requests for state appropriations will not be submitted to the Office of Financial Management for Governor or legislative consideration without this update.

Attach a copy of the College Board of Trustees resolution for every change.

**List of programs impacted by project at each milestone:**

<b>College Proposal</b>	<b>Design-Build funding request</b>	<b>Predesign to OFM</b>	<b>Construction-phase Reappropriation</b>
<i>December 2017</i>	<i>August 2023</i>	<i>TBD</i>	<i>TBD</i>
Visual Arts	Visual Arts		
Performing Arts	Performing Arts		
Music	Music		
Multimedia	Multimedia		
Innovation Center	Innovation Center		

# TAB D – Grants

## 1. CTC Energy Efficiency Program



# 699 - Community and Technical College System Capital Project Request

2023-25 Biennium

\*

Version: U1 SBCTC 2024 Supplemental Cap. Budget

Report Number: CBS002

Date Run: 9/4/2023 4:51PM

Project Number: 40000880

Project Title: CTC Energy Efficiency Program

## Description

Starting Fiscal Year: 2024

Project Class: Grant

Agency Priority: 3

### Project Summary

The State Board for Community and Technical Colleges (SBCTC) requests \$2 million for grants to improve building and energy efficiency projects for the community and technical colleges in Washington State. This funding will help the system improve building performance, extend the life of building systems, reduce greenhouse gas emissions and ongoing operating costs, and improve occupant comfort through retro-commissioning building systems that are operating below desired efficiency.

### Project Description

**What is the problem/opportunity? Identify: priority, underserved people/communities, operating budget savings, public safety improvements.**

The Washington state community and technical college system owns 1,066 buildings, including more than 22 million square feet of space across 34 colleges. Based on the most recent construction or major renovation date, the weighted, average age of system building area is roughly 26 years old. The 2021 facility condition survey concluded that 43% of college buildings had a condition that ranked lower than "adequate." This represents 32% of the total building area owned by the system.

Many of these buildings have degraded or underperforming systems that may not function as efficiently as originally designed. State capital and operating budgets do not include funding to regularly recalibrate these systems, which results in inefficient energy use, added energy costs, and harm to the environment.

**What will the request produce or construct (i.e., design of a building, construction of additional space, etc.)?**

As buildings age, major systems become less reliable and efficient due to the degradation of physical components and equipment control systems.

With the requested funding, the State Board for Community and Technical Colleges will allocate funds to colleges through a competitive selection process to retro-commission aging and underperforming building systems, ensuring buildings run at their optimal performance. Retro-commissioning projects will improve energy efficiency, extend equipment life, reduce greenhouse gas emissions, and reduce operating expenses.

**How would the request address the problem or opportunity identified in question #1? What would be the result of not taking action?**

A retro-commissioning effort will identify underperforming systems and repair, or replace, failed equipment. Projects will reduce energy consumption and quickly provide operational savings that exceed the cost of the initial investment. In addition, better performing buildings will help extend the life of building components, reduce greenhouse gas emissions, and help the community and technical college system meet clean building standards.

Not retro-commissioning building systems will perpetuate costly problems, waste energy, and maintain the status quo when our state is focused on addressing climate change.

**What alternatives were explored? Why was the recommended alternative chosen?**

While there are many ways to improve sustainability in the built environment, re-commissioning strategies are cost-effective, quick to implement, scientifically proven, direct, and measurable.

**Which clientele would be impacted by the budget request? Where and how many units would be added, people or communities served, etc.**

This project will directly affect the nearly 272,000 students who enroll in Washington's 34 community and technical colleges

699 - Community and Technical College System  
Capital Project Request

2023-25 Biennium

\*

Version: U1 SBCTC 2024 Supplemental Cap. Budget

Report Number: CBS002

Date Run: 9/4/2023 4:51PM

Project Number: 40000880

Project Title: CTC Energy Efficiency Program

**Description**

each year. Students, staff and visitors will benefit from greater energy efficiency, reduced operating costs and, in many cases, improved temperature control. The public will benefit from actions that help protect the environment and the longevity of public assets.

**Does this project or program leverage non-state funding? If yes, how much by source?**

No. However, retro-commissioning efforts reduce ongoing operating and maintenance costs by ensuring building systems are optimally tuned and staff are properly trained.

**Describe how this project supports the agency’s strategic master plan or would improve agency performance.**

**Reference feasibility studies, master plans, space programming and other analyses as appropriate.**

Washington’s 34 community and technical colleges serve nearly 272,000 students each year in local communities across the state. This capital project request supports Goal 4 of SBCTC’s strategic plan: “Secure resources and develop systemwide strategies to support colleges’ financial sustainability and resiliency.” This project will support colleges’ financial health by measuring building energy use, finding operating efficiencies and savings through improved efficiencies, and avoiding non-compliance penalties.

**Does this project include IT related costs, including hardware, software, cloud based services, contracts or staff? If yes, attach IT Addendum.**

No.

**If the project is linked to the Puget Sound Action Agenda, describe the impacts on the Action Agenda, including expenditure and FTE detail. See Chapter 12 Puget Sound Recovery) in the 2021-23 Operating Budget Instructions.**

Not applicable.

**How does this project contribute to meeting the greenhouse gas emissions limits established in RCW70A.45.050, Clean Buildings performance standards in RCW 9.27A.210, or other statewide goals to reduce carbon pollution and/or improve efficiency?**

This project directly impacts the community and technical college system’s ability to meet state goals intended to reduce greenhouse gas emissions and energy consumption in buildings. Fine-tuning buildings and building systems will reduce greenhouse gas emissions and energy use while lowering operating costs.

**How does this project impact equity in the state? Which communities are impacted by this proposal? Include both demographic and geographic communities. How are disparities in communities impacted?**

All 34 community and technical colleges have buildings that qualify under the Clean Buildings Act. As a statewide network of higher education institutions, this project will benefit and support students and communities statewide.

Community and technical colleges are inclusive and diverse. Our students are more likely to be the first in their families to attend college, come from lower-income families, be people of color, hold down jobs, and care for parents or children. The median age is 26.

**Is there additional information you would like decision makers to know when evaluating this request?**

Most efforts to reduce building energy use require significant capital investments and can take many years to plan and accomplish. A retro-commissioning effort has a high and immediate return on investment and can be completed quickly to provide years of benefit into the future. The results of this effort will multiply the positive effect of parallel actions to reduce building energy use.

**Location**

City: Statewide

County: Statewide

Legislative District: 098

**699 - Community and Technical College System  
Capital Project Request**

2023-25 Biennium

\*

Version: U1 SBCTC 2024 Supplemental Cap. Budget

Report Number: CBS002

Date Run: 9/4/2023 4:51PM

Project Number: 40000880

Project Title: CTC Energy Efficiency Program

**Description**

**Project Type**

Facility Preservation (Minor Works)  
Grants

**Grant Recipient Organization:** WA Community and Technical Colleges

**RCW that establishes grant:** N/A

**Application process used**

SBCTC will use a competitive process to ensure all community and technical colleges have an opportunity to apply for and receive grants. SBCTC intends to award grants in two phases. First, with planning grants to select the buildings and develop scopes of work, and then to implement retrocommissioning projects based on the potential energy savings and return on investment. SBCTC will convene a group of CTC Operation and Facility Directors to develop criteria and prioritize retrocommissioning projects. Criteria will consider facility and equipment age, commissioning/recommissioning history, service/repair history, occupant comfort, and energy efficiency.

**Growth Management impacts**

N/A

**Funding**

Acct Code	Account Title	Estimated Total	Expenditures		2023-25 Fiscal Period	
			Prior Biennium	Current Biennium	Reappropriations	New Appropriations
26C-1	Climate Commit Accou-State	2,000,000				2,000,000
	<b>Total</b>	<b>2,000,000</b>	<b>0</b>	<b>0</b>	<b>0</b>	<b>2,000,000</b>
<b>Future Fiscal Periods</b>						
		<u>2025-27</u>	<u>2027-29</u>	<u>2029-31</u>	<u>2031-33</u>	
26C-1	Climate Commit Accou-State					
	<b>Total</b>	<b>0</b>	<b>0</b>	<b>0</b>	<b>0</b>	

**Operating Impacts**

No Operating Impact

**Narrative**

There are potential energy and operating savings that could result from performing retrocommissioning of under performing buildings, including extending the life of building mechanical systems.

**Capital Project Request**

**2023-25 Biennium**

\*

<b><u>Parameter</u></b>	<b><u>Entered As</u></b>	<b><u>Interpreted As</u></b>
Biennium	2023-25	2023-25
Agency	699	699
Version	U1-A	U1-A
Project Classification	*	All Project Classifications
Capital Project Number	40000880	40000880
Sort Order	Project Priority	Priority
Include Page Numbers	Y	Yes
For Word or Excel	N	N
User Group	Agency Budget	Agency Budget
User Id	*	All User Ids

# TAB E – Certificate of Participation

## 1. Renton Technical College – Building J Renovation







**Reasons for acquisition and how this project relates to the college's facilities master plan, the strategic plan, and institutional goals:**

Both the current version of the Facilities Master Plan and its predecessor have specifically identified a need to improve wayfinding and access to critical programs and services. This project will directly improve access and visibility to the college community and to prospective students. Making this program and career path more accessible, visible, and usable furthers the college's goals to make career paths attainable to a diverse student body.

The space will allow RTC to expand enrollment in programs because they are in such high demand. RTC has typically taken in 24 in previous cohorts, we will now be able to take in 32. Other programs will be able to utilize the space as well. This will also allow us to expand the number of students that leave RTC with a bachelor's degree.

The space will allow us to expand community outreach by cooperating with other institutions and programs, such as Renton High School, MINT Mentors in Training, etc.



**FISCAL HEALTH MEASURE**

Use the following criteria for your analysis:

**Operating Revenue:**

Funds: 145, 148, 149, 4xx (except 444), 5xx  
 GL: 32xx  
 SrcRev: All except 03xx, 06xx, 07xx and 08xx  
 GL: 65xx  
 Exp Obj: Sx

**Debt:**

Funds: All except 0xx, 253, 444, 790, 840  
 GL: 5xxx except 5116, 5124, 5125, 5127, 5128, 5153, 5155, 5158, 5192, 5225, 5227, 5228

Previous fiscal year (e.g., 2018)	<b>(current)</b>	2023
First full fiscal year of debt service for proposed financing	<b>(future)</b>	2024
Current debt service		\$168,400
Current operating revenue		/ \$14,619,484
Current debt service / operating revenue		= 1.2%
Future debt service without proposed project requiring financing		\$170,200
Future debt service due to proposed project requiring financing <b>(a) from page 2</b>		+ \$160,000
Future debt service	<b>(A)</b>	= \$330,200
Future operating revenue without proposed project requiring financing		\$11,242,991
Future operating revenue due to proposed project requiring financing		+ \$200,000
Future operating revenue	<b>(B)</b>	= \$11,442,991
<b>Future debt service / operating revenue</b>	<b>(A/B)</b>	= <b>2.9 %</b>

## ELIGIBILITY FOR TAX EXEMPT FINANCING

*Treasurer's questions to help ensure compliance with Internal Revenue Service (IRS) regulations for tax-exempt financings.*

1. Will any portion of the project or asset ever be **owned by** any entity other than the State or one of its agencies or departments?  Yes  No
2. Will any portion of the project or asset ever be **leased to** any entity other than the State or one of its agencies or departments?  Yes  No
3. Will any portion of the project or asset ever be **managed or operated** by any entity other than the State or one of its agencies or departments?  Yes  No
4. Will any portion of the project or asset be used to perform **sponsored research** under an agreement with a nongovernmental entity\*?  Yes  No
5. Does the project involve a **public/private venture**, or will any entity other than the State or one of its agencies or departments ever have a **special priority or other right** to use any portion of the project or asset to purchase or otherwise acquire any output of the project or asset such as electric power or water supply?  Yes  No
6. Will any portion of the Bond/COP proceeds be **granted or transferred** to nongovernmental entities or granted or transferred to other governmental entities which will use the grant for nongovernmental purposes?  Yes  No
7. If you have answered "**Yes**" to any of the questions above, will your agency or any other State agency **receive any payments** from any nongovernmental entity, for the use of, or in connection with, the project or asset?  Yes  No
8. Is any portion of the project or asset, or rights to any portion of the project or asset, expected to be **sold to** any entity other than the State or one of its agencies or departments?  Yes  No
9. Will any portion of the Bond/COP proceeds be **loaned to** nongovernmental entities or loaned to other governmental entities that will use the loan for nongovernmental purposes?  Yes  No
10. Will any portion of the Bond/COP proceeds be used for **staff costs for tasks not directly related** to a financed project(s)?  Yes  No

\*A nongovernmental entity is defined as:

- a) any person or private entity, such as a corporation, partnership, limited liability company, or association;
- b) any nonprofit corporation (including any 501(c)(3) organization);
- c) the federal government (including any federal department or agency).

### Determining eligibility:

If all of the answers to the questions above are "No", request tax-exempt funding. If the answer to any of the questions is "Yes", contact the SBCTC Capital Budget Office for further review.